

RODLESS BELT-DRIVE ELECTRIC ACTUATOR B3W

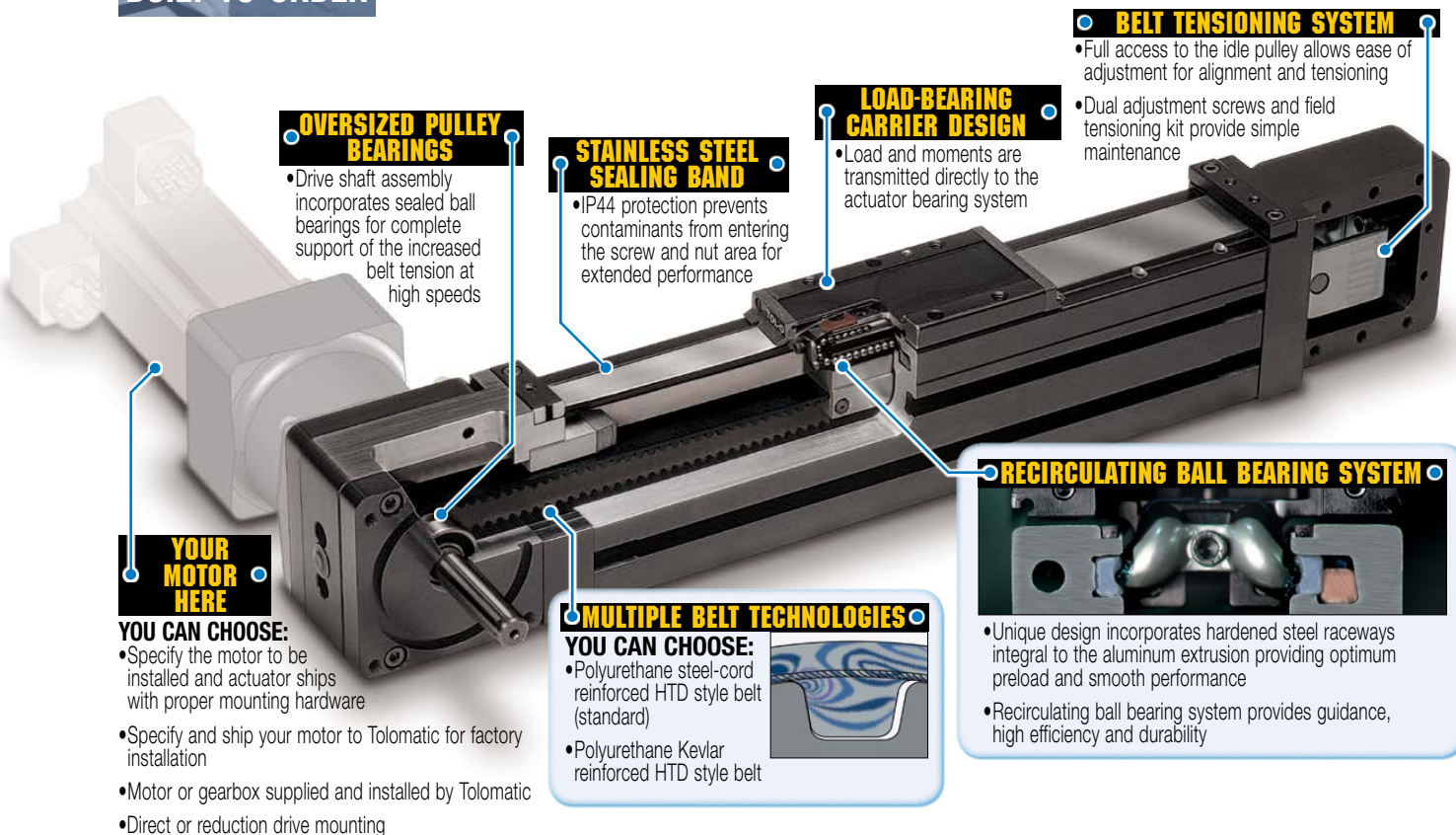

With large bending moment capacity, the B3W utilizes an integral recirculating ball bearing guidance system that provides durable performance and extremely long life.



Available Options:

Carrier Options

Auxiliary Carrier; Dual 180° Carrier

Mounting Options

Surface Mount; Tube Supports; Mounting Plates

Metric Option

Provides metric tapped holes

Sensors

With integrated mounting bracket

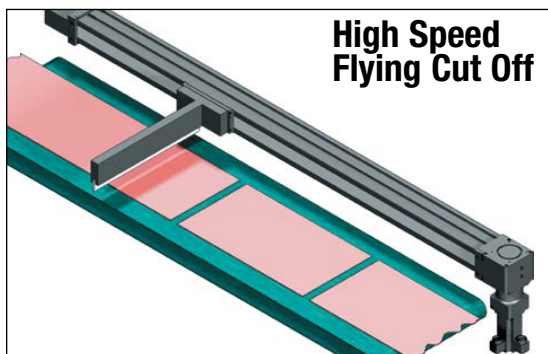

Applications:

- Adhesive dispensing
- Aligning
- Animation
- Assembly
- Automotive
- Camera positioning
- Conveyors
- Cutting
- Diverters
- Inspection
- Laser marking
- Material cutting
- Milling
- Packaging equipment
- Parts transfer
- Pick & place
- Positioning
- Product handling
- Slitting
- Sorting
- Spraying
- Stacking
- Table positioning
- Test stations
- Wire winding
- X-Y Gantry/ Multi-Axis

RODLESS BELT-DRIVE ELECTRIC ACTUATOR

SPECIFICATIONS

CARRIER	SIZE	MAXIMUM BENDING MOMENTS						MAX. LOAD				MAX. THRUST	
		M _x		M _y		M _z		F _y		F _z		N	
		N-m	in-lbs	N-m	in-lbs	N-m	in-lbs	N	lb	N	lb	N	lbf
Standard	10	28.2	250	30.4	269	17.6	156	1517	341	2629	591	667	150
	15	97	859	117	1033	67	596	3737	840	6468	1454	1112	250
	20	188	1662	166	1472	96	850	5155	1159	8932	2008	1440	325
Dual 180°	10	74	657	35.3	312	61	538	5258	1182	3034	682	667	150
	15	279	2468	135	1192	233	2066	12935	2908	7473	1680	1112	250
	20	512	4527	192	1700	333	2944	17864	4016	10311	2318	1440	325

NOTE: Auxiliary Carrier option increases maximum bending moments and load, see B3 brochure 3600-4176 for complete details.

B3W



Dimensions

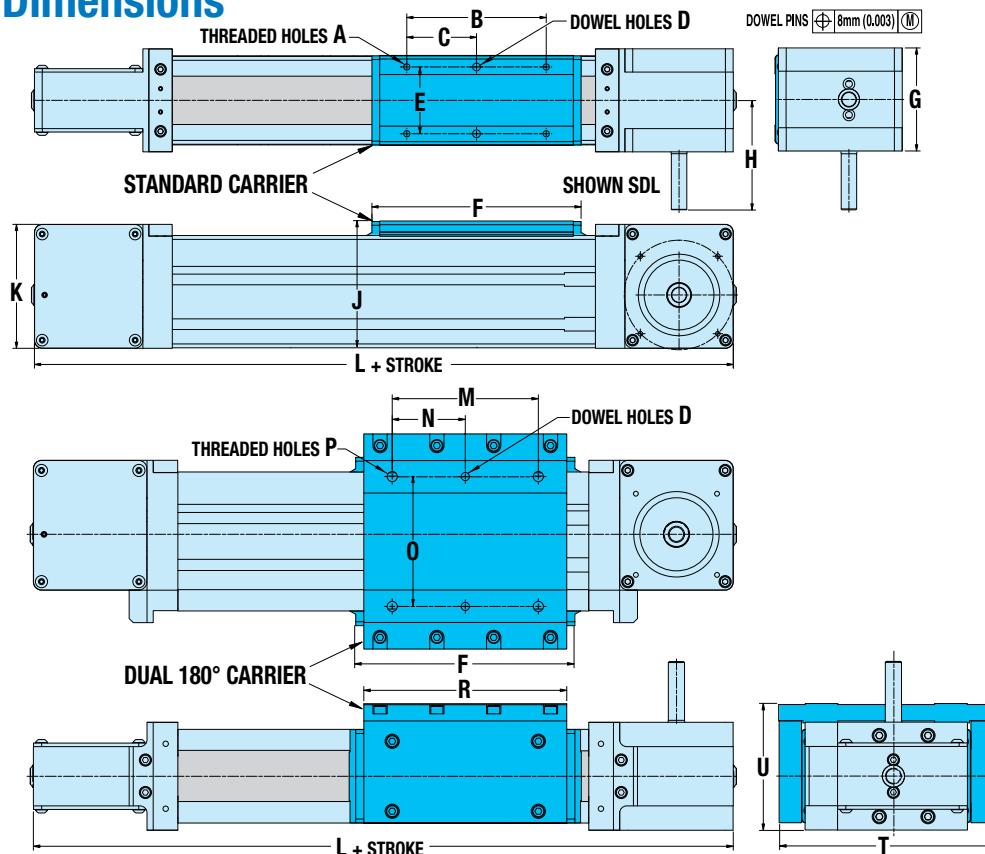

	10	15	20
A	M6-1.0 9.4 DP	M6-1.0 10.2 DP	M8-1.25 14.2 DP
B	57.15	114.3	120.65
C	28.58	57.15	60.33
D	6.045/ 6.020 6.4 DP	6.045/ 6.020 6.4 DP	6.045/ 6.020 6.4 DP
E	45.24	54.76	79.30
F	103.6	171.5	184.1
G	57.2	73.0	107.9
H	76.1	89.7	98.3
J	82.0	104.3	117.9
K	79.4	101.6	114.3
L	316.2	420.2	431.6
M	77.77	114.30	152.40
N	38.89	57.15	76.20
O	82.55	101.60	136.53
P	M6-1.0 6.4 DP	M8-1.25 15.0 DP	M10-1.5 16.8 DP
R	93.3	158.8	171.5
T	131.1	168.3	192.8
U	72.6	99.0	119.5

Dimensions in millimeters
For reference only. Use CAD files for
any critical dimensions



USA

3800 County Road 116
Hamel, MN 55340, USA
Phone: (763) 478-8000
Fax: (763) 478-8080
Toll-Free: **1-800-328-2174**
sales@tolomatic.com
www.tolomatic.com

CHINA

**Tolomatic Automation Products
(Suzhou) Co. Ltd.**
(ServoWeld® inquiries only)
No. 60 Chuangye Street, Building 2
Huqiu District, SND Suzhou
Jiangsu 215011 - P.R. China
Phone: +86 (512) 6750-8506
Fax: +86 (512) 6750-8507
ServoWeldChina@tolomatic.com

EUROPE

Tolomatic Europe GmbH
Zeilweg 42
60439 Frankfurt am Main
Germany
Phone: +49 69-2045-7837
EuropeSales@tolomatic.com

COMPANY WITH
QUALITY SYSTEM
CERTIFIED BY DNV GL
= ISO 9001 =
Certified site: Hamel, MN

All brand and product names are trademarks or registered trademarks of their respective owners. Information in this document is believed accurate at time of printing. However, Tolomatic assumes no responsibility for its use or for any errors that may

appear in this document. Tolomatic reserves the right to change the design or operation of the equipment described herein and any associated motion products without notice. Information in this document is subject to change without notice.

Visit www.tolomatic.com for the most up-to-date technical information