



Temporary Power

Rhino-Hide® Single Pole Cam Devices	I-2
15 Series Single Pole Devices	I-5
16 Series Single Pole Devices	I-7
18 Series Single Pole Devices	I-14
17 Series Single Pole Devices	I-17
19 Series Single Pole Devices	I-19
22 Series Single Pole Devices	I-20
23 Series Single Pole Devices	I-22
49 Series Single Pole Devices	I-25
Portable Outlet Boxes, Covers and Grips	I-30
Portable GFCI Devices	I-36
GFCI User Attachable Devices	I-39
Power Distribution Box and Power Cords	I-40

Rhino-Hide® Single Pole Cam Devices

Industrial Grade Connectors for Temporary and Semi-Permanent Power Distribution Applications

Rhino-Hide® Single Pole Cam-Type Devices are designed to provide superior service and durability, even under the most severe operating conditions.

15 Series Taper Nose mini-cam plugs and receptacles are ideal for entertainment applications such as those found at carnivals and theme parks.

16 Series Taper Nose Cam-Type Devices are the devices of choice for power distribution applications such as construction sites, mining operations, concerts, sound stages, movie/television productions, sporting events and conventions.

18 Series Single Pole Ball Nose Cam-Type Devices are typically favored by the broadcasting and welding industries.

17 & 19 Series Taper and Ball Nose devices can withstand grueling, heavy-duty industrial use. Preferred applications for these series include generator test stations, water purification plants, electrochemical machining equipment and general industrial uses.

22 & 23 Series Single Pole Latching Cam-Type devices feature an additional latching mechanism for added security, especially in high-vibration applications. These devices can also be retrofitted to existing locations and power distribution systems, allowing for an effortless installation. These plugs are commonly used to provide power to ships at dock side, and are recognized by ETL Labs to meet U.S. Navy specifications.

49 Series Single Pole High Amperage Devices

Rhino-Hide® 49 Series single pole devices are designed to deliver up to 1135 Amps at 1000 volts, AC or DC, under the most extreme conditions with cables ranging in size from 313 MCM to 777 MCM. Rhino-Hide® 49 Series products are ideal for demanding applications requiring continuous, reliable high-amperage power in multi phases. Typical locations where these products are used include oil and gas rigs, silicon-controlled rectifiers (SCRs), generator stations and other heavy industrial applications.



Cam-Type Devices

Features and Benefits

Rhino-Hide® Single Pole Cam-Type Connectors from Leviton supply temporary electrical power distribution for multiple indoor and outdoor applications.

Common Applications

- Motor and generator splices
- Mining and construction sites
- Commercial and navy shipbuilding and repair
- Other temporary power applications

Cam-Type Devices for Commercial and Industrial Use

- Plugs are available in set screw or crimp tube termination, taper nose and ball nose configurations
- Intermateable and compatible with competitive cam-type products — can be retrofitted to existing locations and power distribution systems
- Shatter and crack proof — high durometer thermoplastic vulcanizate (TPV) or Neoprene™ rubber
- Color-coded insulating sleeves provide fast and easy phase identification
- Self compensating for wear — slit in male contact provides spring action for longer usage
- Quick connect/disconnect
- High conductivity — positive, vibration-proof connection provided by cam design
- Wide range of applications — usable with a wide range of cable and amperage ratings
- Meets NEC requirements and is UL Listed and CSA Certified; NEMA 3R-rated for use in outside locations

Experience the Difference

Rhino-Hide® Single Pole Cam-Type Connectors are designed for easy assembly and disassembly without special tools. A thermoplastic screw is used to tightly secure the contact inside the insulating sleeve, making assembly, disassembly and field repairs effortless. The plugs use plastic locking and reinforcement rings molded into insulating sleeves and receptacles, ensuring the integrity of the connection. Under severe stress and load conditions, these rings will not melt, break or crack.

Single Pole Devices



Cam-Type Connectors

Rhino-Hide® Single Pole | **Industrial**



Cam-Type Plugs

For applications up to 400A, 600V AC or DC



Cam-Type Plugs

Connector Type	Component	Description	Standards and Certifications (NEMA, UL, CSA)
15, 16, 18 Series Plugs	Sleeve*	Thermoplastic Vulcanizate (TPV)	See individual pages throughout this section for specific Standards and Certifications information
	Contact	Brass	
	Strain-Relief	Copper Wire	
17, 19, 22/23 Series Plugs	Sleeve**	Neoprene™	See individual pages throughout this section for specific Standards and Certifications information
	Contact	Brass	
	Strain-Relief	Copper Wire	

*"V" Series Neoprene™.

**22L22-S and 22L25-S Series: TPV

Color Choices Rhino-Hide® Cam-Type devices are offered in a wide range of colors. To order colors, add suffix to Cat. No.



White
(-W)



Black
(-E)



Brown
(-H)



Gray
(-G/-GY)



Red
(-R)



Blue
(-B)



Orange
(-O)



Green
(-G)



Yellow
(-Y)

15 Series

Taper Nose, Cam-Type Plugs

150A, 600VAC/DC Max — NEMA 3R Rated for Outdoor Use

The 15 Series Taper Nose mini-cam plugs, receptacles and connectors are tough and reliable. Primary applications include carnivals and theme parks, as well as the entertainment industry.

15 Series Cam-Type Plugs (up to 150A, 600V) — UL/CSA 1691 Listed

15 Series, Taper Nose — Cam-Type Plugs			
		Male Plug	Female Plug
Description	Color	Cat. No.	Cat. No.
Single Set Screw Termination Cable Size: #8 - #2 Max Ampacity: 150A Voltage: 600VAC/DC	White	15D21-UW	15D22-UW
	Black	15D21-UE	15D22-UE
	Brown	15D21-UH	15D22-UH
	Red	15D21-UR	15D22-UR
	Blue	15D21-UB	15D22-UB
	Orange	15D21-UO	15D22-UO
	Green	15D21-UG	15D22-UG
	Yellow	15D21-UY	15D22-UY
	Replacement Contacts	—	15D21-UC
Crimp Tube Termination Cable Size: #8 - #4 Max Ampacity: 140A Voltage: 600VAC/DC	White	15D23-UW	15D24-UW
	Black	15D23-UE	15D24-UE
	Brown	15D23-UH	15D24-UH
	Red	15D23-UR	15D24-UR
	Blue	15D23-UB	15D24-UB
	Orange	15D23-UO	15D24-UO
	Green	15D23-UG	15D24-UG
	Yellow	15D23-UY	15D24-UY
	Replacement Contacts	—	15D23-UC



15D22-UG



15D23-UW



15D24-UG

15 Series — Replacement Sleeves			
		Male	Female
Description	Color	Cat. No.	Cat. No.
Sleeves	White	15SDM-1UW	15SDF-1UW
	Black	15SDM-1UE	15SDF-1UE
	Brown	15SDM-1UH	15SDF-1UH
	Red	15SDM-1UR	15SDF-1UR
	Blue	15SDM-1UB	15SDF-1UB
	Orange	15SDM-1UO	15SDF-1UO
	Green	15SDM-1UG	15SDF-1UG
	Yellow	15SDM-1UY	15SDF-1UY

Note: Contact factory for availability



Related Products

To accommodate everyday use Leviton offers a variety of 15 Series accessories.
See page I-24 for more information.

15 Series

Rhino-Hide® Single Pole | Receptacles | Industrial



15 Series Cam-Type Panel Mount Receptacles (150A, 600V) — UL/CSA 1691 Listed

15 Series, Taper Nose — Panel Mount Receptacle

		Male	Female	Male/Female
Description	Color	Cat. No.	Cat. No.	Cat. No.
.5" Threaded Stud Termination Cable Size: #8 - #2 Max Ampacity: 150A Voltage: 600VAC/DC	White	15R21-UW	15R22-UW	—
	Black	15R21-UE	15R22-UE	—
	Brown	15R21-UH	15R22-UH	—
	Red	15R21-UR	15R22-UR	—
	Blue	15R21-UB	15R22-UB	—
	Orange	15R21-UO	15R22-UO	—
	Green	15R21-UG	15R22-UG	—
	Yellow	15R21-UY	15R22-UY	—
.75" Threaded Stud Termination Cable Size: #8 - #2 Max Ampacity: 150A Voltage: 600VAC/DC	White	15R21-1UW	15R22-1UW	—
	Black	15R21-1UE	15R22-1UE	—
	Brown	15R21-1UH	15R22-1UH	—
	Red	15R21-1UR	15R22-1UR	—
	Blue	15R21-1UB	15R22-1UB	—
	Orange	15R21-1UO	15R22-1UO	—
	Green	15R21-1UG	15R22-1UG	—
	Yellow	15R21-1UY	15R22-1UY	—

Note: Contact factory for availability



15R21-UR



15S31-UR

15 Series Protective Covers and Caps

15 Series - Covers

		Male	Female	Male/Female
Description	Color	Cat. No.	Cat. No.	Cat. No.
Enclosure Cable Size: #8 - #2 Max Ampacity: 150A Voltage: 600VAC/DC	White	—	—	15S31-UW
	Black	—	—	15S31-UE
	Brown	—	—	15S31-UH
	Red	—	—	15S31-UR
	Blue	—	—	15S31-UB
	Orange	—	—	15S31-UO
	Green	—	—	15S31-UG
	Yellow	—	—	15S31-UY

15 Series — Caps

		Male	Female	Male/Female
Description	Color	Cat. No.	Cat. No.	Cat. No.
Enclosure Cable Size: #8 - #2 Max Ampacity: 150A Voltage: 600VAC/DC	White	15P21-UW	15P22-UW	—
	Black	15P21-UE	15P22-UE	—
	Red	15P21-UR	15P22-UR	—
	Blue	15P21-UB	15P22-UB	—
	Green	15P21-UG	15P22-UG	—

Note: 15S31 devices are NOT UL/CSA 1691 Listed

Ampacity Table

Ampacity Ratings

Cable Size	Ampacity
#8	80
#6	105
#4	190
#2	916

Excerpted from NEC Article 400, Table 400.5(A)(2), 90° column



Related Products

To accommodate everyday use Leviton offers a variety of 15 Series accessories.

See page I-24 for more information.

16 Series

Taper Nose, Cam-Type Plugs

400A, 600VAC/DC Max — NEMA 3R Rated for Outdoor Use

The 16 Series Taper Nose products are the connectors of choice for concerts, sound stages, movie-making, television production, sporting events and conventions.

16 Series Cam-Type Plugs (up to 190A, 600V) — UL/CSA 1691 Listed

16 Series, Taper Nose — Cam-Type Plugs			
		Male Plug	Female Plug
Description	Color	Cat. No.	Cat. No.
Double Set Screw Termination Cable Size: #6 - #2 Max Ampacity: 190A Voltage: 600VAC/DC	White	16D44-UW	16D45-UW
	Black	16D44-UE	16D45-UE
	Brown	16D44-UH	16D45-UH
	Red	16D44-UR	16D45-UR
	Blue	16D44-UB	16D45-UB
	Orange	16D44-UO	16D45-UO
	Green	16D44-UG	16D45-UG
	Yellow	16D44-UY	16D45-UY
Crimp Tube Termination Cable Size: #2 - #1 Max Ampacity: 220A Voltage: 600VAC/DC	White	16D25-UW	16D34-UW
	Black	16D25-UE	16D34-UE
	Brown	16D25-UH	16D34-UH
	Red	16D25-UR	16D34-UR
	Blue	16D25-UB	16D34-UB
	Orange	16D25-UO	16D34-UO
	Green	16D25-UG	16D34-UG
	Yellow	16D25-UY	16D34-UY
Single Set Screw Termination Cable Size: #2 - 2/0 Max Ampacity: 300A Voltage: 600VAC/DC	White	16D21-UW	16D29-UW
	Black	16D21-UE	16D29-UE
	Brown	16D21-UH	16D29-UH
	Red	16D21-UR	16D29-UR
	Blue	16D21-UB	16D29-UB
	Orange	16D21-UO	16D29-UO
	Green	16D21-UG	16D29-UG
	Yellow	16D21-UY	16D29-UY
Double Set Screw Termination Cable Size: #2 - 2/0 Max Ampacity: 300A Voltage: 600VAC/DC	White	16D22-UW	16D31-UW
	Black	16D22-UE	16D31-UE
	Brown	16D22-UH	16D31-UH
	Red	16D22-UR	16D31-UR
	Blue	16D22-UB	16D31-UB
	Orange	16D22-UO	16D31-UO
	Green	16D22-UG	16D31-UG
	Yellow	16D22-UY	16D31-UY
Replacement Contacts	—	16D22-UC	16D31-UC
Crimp Tube Termination Cable Size: 1/0 - 2/0 Max Ampacity: 300A Voltage: 600VAC/DC	White	16D26-UW	16D35-UW
	Black	16D26-UE	16D35-UE
	Brown	16D26-UH	16D35-UH
	Red	16D26-UR	16D35-UR
	Blue	16D26-UB	16D35-UB
	Orange	16D26-UO	16D35-UO
	Green	16D26-UG	16D35-UG
	Yellow	16D26-UY	16D35-UY

Note: Contact factory for availability





16 Series

Rhino-Hide® Single Pole | Plugs | Replacement Sleeves | **Industrial**



16 Series Cam-Type Plugs (up to 400A, 600V) — UL/CSA 1691 Listed

16 Series, Taper Nose — Cam-Type Plugs  			
		Male Plug	Female Plug
Description	Color	Cat. No.	Cat. No.
Single Set Screw Termination	White	16D23-UW	16D32-UW
Cable Size: 2/0 - 4/0	Black	16D23-UE	16D32-UW
Max Ampacity: 400A	Brown	16D23-UH	16D32-UH
Voltage: 600VAC/DC	Red	16D23-UR	16D32-UR
	Blue	16D23-UB	16D32-UB
	Orange	16D23-UO	16D32-UO
	Green	16D23-UG	16D32-UG
	Yellow	16D23-UY	16D32-UY
Double Set Screw Termination	White	16D24-UW	16D33-UW
Cable Size: 2/0 - 4/0	Black	16D24-UE	16D33-UE
Max Ampacity: 400A	Brown	16D24-UH	16D33-UH
Voltage: 600VAC/DC	Red	16D24-UR	16D33-UR
	Blue	16D24-UB	16D33-UB
	Orange	16D24-UO	16D33-UO
	Green	16D24-UG	16D33-UG
	Yellow	16D24-UY	16D33-UY
Replacement Contacts	—	16D24-UC	16D33-UC
Crimp Tube Termination	White	16D28-UW	16D37-UW
Cable Size: 3/0 - 4/0	Black	16D28-UE	16D37-UE
Max Ampacity: 400A	Brown	16D28-UH	16D37-UH
Voltage: 600VAC/DC	Red	16D28-UR	16D37-UR
	Blue	16D28-UB	16D37-UB
	Orange	16D28-UO	16D37-UO
	Green	16D28-UG	16D37-UG
	Yellow	16D28-UY	16D37-UY



16D23-UB



16D32-UW



16D24-UR



16D37-UG

16 Series — Replacement Sleeves (TPV)			
		Male Plug	Female Plug
Description	Color	Cat. No.	Cat. No.
For Plugs 1/0 to 4/0	White	16SDM-1UW	16SDF-1UW
Replacement Sleeves	Black	16SDM-1UE	16SDF-1UE
	Brown	16SDM-1UH	16SDF-1UH
	Red	16SDM-1UR	16SDF-1UR
	Blue	16SDM-1UB	16SDF-1UB
	Orange	16SDM-1UO	16SDF-1UO
	Green	16SDM-1UG	16SDF-1UG
	Yellow	16SDM-1UY	16SDF-1UY
For Plugs #2 - 2/0	White	16SDM-2UW	16SDF-2UW
Replacement Sleeves	Black	16SDM-2UE	16SDF-2UE
	Brown	16SDM-2UH	16SDF-2UH
	Red	16SDM-2UR	16SDF-2UR
	Blue	16SDM-2UB	16SDF-2UB
	Orange	16SDM-2UO	16SDF-2UO
	Green	16SDM-2UG	16SDF-2UG
	Yellow	16SDM-2UY	16SDF-2UY

Note: Contact factory for availability



Related Products

To accommodate everyday use Leviton offers a variety of 16 Series accessories.
See page I-24 for more information.

16 Series Cam-Type Plugs (up to 400A, 600V)

16 Series, Taper Nose — Cam-Type Plugs			
		Male Plug	Female Plug
Description	Color	Cat. No.	Cat. No.
Crimp Tube Termination	White	16V22-W	16V26-W
Cable Size: 1/0 - 2/0	Black	16V22-E	16V26-E
Max Ampacity: 300A	Brown	16V22-H	16V26-H
Voltage: 600V	Red	16V22-R	16V26-R
Neoprene™ Sleeve	Blue	16V22-B	16V26-B
	Orange	16V22-O	16V26-O
	Green	16V22-G	16V26-G
	Yellow	16V22-Y	16V26-Y
Crimp Tube Termination	White	16V24-W	16V28-W
Cable Size: 3/0 - 4/0	Black	16V24-E	16V28-E
Max Ampacity: 400A	Brown	16V24-H	16V28-H
Voltage: 600V	Red	16V24-R	16V28-R
Neoprene™ Sleeve	Blue	16V24-B	16V28-B
	Orange	16V24-O	16V28-O
	Green	16V24-G	16V28-G
	Yellow	16V24-Y	16V28-Y
Double Set Screw Termination	White	16D40-U	16D41-U
Cable Size: 1/0 - 4/0			
Max Ampacity: 400A			
Voltage: 600VAC/DC			
Flame Retardant			





Temporary Power

Taper Nose, Panel Mount Receptacles

400A, 600VAC/DC Max — NEMA 3R Rated for Outdoor Use

Leviton's single pole panel receptacles are designed to provide superior service and durability, even under the most severe operating conditions. These devices are ideal for use in equipment associated with concerts, sound stages, movie-making, television production and many other power distribution applications. Leviton's 16 Series single pole panel receptacles and accessories are UL/CSA 1691 Listed and are completely interoperable and interchangeable with competitive cam-type plugs and receptacles.

16 Series Panel Mount Receptacles (400A, 600V) — UL/CSA 1691 Listed

16 Series, Taper Nose — Panel Mount Receptacle  			
		Male 90°	Female 90°
Description	Color	Cat. No.	Cat. No.
Double Set Screw Termination	White	16R21-UW	16R22-UW
Cable Size: 2/0 - 4/0	Black	16R21-UE	16R22-UE
Max Ampacity: 400A	Brown	16R21-UH	16R22-UH
Voltage: 600VAC/DC	Red	16R21-UR	16R22-UR
	Blue	16R21-UB	16R22-UB
	Orange	16R21-UO	16R22-UO
	Green	16R21-UG	16R22-UG
	Yellow	16R21-UY	16R22-UY



Note: Contact factory for availability

Continued on next page

16 Series

Rhino-Hide® Single Pole | Receptacles | Industrial



Continued from previous page

16 Series Panel Mount Receptacles (400A, 600V) — UL/CSA 1691 Listed

16 Series, Taper Nose — Panel Mount Receptacle

		Male 45°	Female 45°
Description	Color	Cat. No.	Cat. No.
Double Set Screw Termination	White	16R27-UW	16R28-UW
Cable Size: 2/0 - 4/0	Black	16R27-UE	16R28-UE
Max Ampacity: 400A	Brown	16R27-UH	16R28-UH
Voltage: 600VAC/DC	Red	16R27-UR	16R28-UR
	Blue	16R27-UB	16R28-UB
	Orange	16R27-UO	16R28-UO
	Green	16R27-UG	16R28-UG
	Yellow	16R27-UY	16R28-UY
		Male 90°	Female 90°
Description	Color	Cat. No.	Cat. No.
.75"L Threaded Stud Termination*	White	16R23-UW	16R24-UW
Cable Size: #2 - 4/0	Black	16R23-UE	16R24-UE
Max Ampacity: 400A	Brown	16R23-UH	16R24-UH
Voltage: 600VAC/DC	Red	16R23-UR	16R24-UR
	Blue	16R23-UB	16R24-UB
	Orange	16R23-UO	16R24-UO
	Green	16R23-UG	16R24-UG
	Yellow	16R23-UY	16R24-UY
With Microswitch			
Description	Color	Cat. No.	
.75"L Threaded Stud Termination*	White	16RSW-UW	—
Cable Size: #2 - 4/0	Black	16RSW-UE	—
Max Ampacity: 400A	Brown	16RSW-UH	—
Voltage: 600VAC/DC	Red	16RSW-UR	—
	Blue	16RSW-UB	—
	Orange	16RSW-UO	—
	Green	16RSW-UG	—
	Yellow	16RSW-UY	—
		Male 45°	Female 45°
Description	Color	Cat. No.	Cat. No.
.75"L Threaded Stud Termination*	White	16R29-UW	16R30-UW
Cable Size: #2 - 4/0	Black	16R29-UE	16R30-UE
Max Ampacity: 400A	Brown	16R29-UH	16R30-UH
Voltage: 600VAC/DC	Red	16R29-UR	16R30-UR
	Blue	16R29-UB	16R30-UB
	Orange	16R29-UO	16R30-UO
	Green	16R29-UG	16R30-UG
	Yellow	16R29-UY	16R30-UY

Note: Contact factory for availability.

*Threaded stud termination type receptacles are available with custom stud lengths, from .75"L to 3.00"L.

Please contact your local sales representative for ordering information and availability



16R27-UG



16R28-UR



16RSW-UG



16R29-UG



Related Products

To accommodate everyday use Leviton offers a variety of 16 Series accessories.

See page I-24 for more information.

16 Series Panel Mount Receptacles (400A, 600V) — UL/CSA 1691 Listed

16 Series, Taper Nose — Panel Mount Receptacle			
Description		Male 90°	Female 90°
	Color	Cat. No.	Cat. No.
1.125"L Threaded Stud Termination*	White	16R23-1UW	16R24-1UW
Cable Size: #2 - 4/0	Black	16R23-1UE	16R24-1UE
Max Ampacity: 400A	Brown	16R23-1UH	16R24-1UH
Voltage: 600VAC/DC	Red	16R23-1UR	16R24-1UR
	Blue	16R23-1UB	16R24-1UB
	Orange	16R23-1UO	16R24-1UO
	Green	16R23-1UG	16R24-1UG
	Yellow	16R23-1UY	16R24-1UY
		Male 90° With Self-Clinching Nut	Female 90° With Self-Clinching Nut
Description	Color	Cat. No.	Cat. No.
1.125"L Threaded Stud Termination*	White	16R25-1UW	16R26-1UW
Cable Size: #2 - 4/0	Black	16R25-1UE	16R26-1UE
Max Ampacity: 400A	Brown	16R25-1UH	16R26-1UH
Voltage: 600VAC/DC	Red	16R25-1UR	16R26-1UR
	Blue	16R25-1UB	16R26-1UB
	Orange	16R25-1UO	16R26-1UO
	Green	16R25-1UG	16R26-1UG
	Yellow	16R25-1UY	16R26-1UY
		Male 90°	Female 90°
Description	Color	Cat. No.	Cat. No.
Add 1.5"L Threaded Stud Termination	White	16R23-4UW	16R24-4UW
Cable Size: #2-4/0	Black	16R23-4UE	16R24-4UE
Max Ampacity: 400A	Brown	16R23-4UH	16R24-4UH
Voltage: 600VAC/DC	Red	16R23-4UR	16R24-4UR
	Blue	16R23-4UB	16R24-4UB
	Orange	16R23-4UO	16R24-4UO
	Green	16R23-4UG	16R24-4UG
	Yellow	16R23-4UY	16R24-4UY
Half Round w/Tapped Hole	White	16R19-UW	16R20-UW
Cable Size: #2 - 4/0	Black	16R19-UE	16R20-UE
Max Ampacity: 400A	Brown	16R19-UH	16R20-UH
Voltage: 600VAC/DC	Red	16R19-UR	16R20-UR
	Blue	16R19-UB	16R20-UB
	Orange	16R19-UO	16R20-UO
	Green	16R19-UG	16R20-UG
	Yellow	16R19-UY	16R20-UY

Note: Contact factory for availability.

*Threaded stud termination type receptacles are available with custom stud lengths, from .75"L to 3.00"L.

Please contact your local sales representative for ordering information and availability





16R19-UE

16 Series

Rhino-Hide® Single Pole | Plugs | Covers and Caps | **Industrial**



16 Series Female Terminal Connectors (400A, 600V)

16 Series, Taper Nose — Female Connectors  			
		Angle	Offset
Description	Color	Cat. No.	Cat. No.
Bus Bar Mount	White	16F21-UW	16F22-UW
Cable Size: #2 - 4/0	Black	16F21-UE	16F22-UE
Max Ampacity: 400A	Brown	16F21-UH	16F22-UH
Voltage: 600VAC/DC	Red	16F21-UR	16F22-UR
	Blue	16F21-UB	16F22-UB
	Orange	16F21-UO	16F22-UO
	Green	16F21-UG	16F22-UG
	Yellow	16F21-UY	16F22-UY

Note: Contact factory for availability

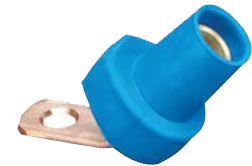

16F21-UB



16F22-UE

16 Series Protective Covers and Caps

16 Series — Covers				
		Male/Female	Male	Female
Description	Color	Cat. No.	Cat. No.	Cat. No.
NEMA 3R Enclosure	White	16S31-UW	—	—
	Black	16S31-UE	—	—
	Brown	16S31-UH	—	—
	Red	16S31-UR	—	—
	Blue	16S31-UB	—	—
	Orange	16S31-UO	—	—
	Green	16S31-UG	—	—
	Yellow	16S31-UY	—	—
	Clear	16S31-UCL	—	—

Note: 16S31 devices are NOT UL/CSA 1691 Listed



16S31-UR



16P22-UE

16 Series — Caps				
		Male/Female	Male	Female
Description	Color	Cat. No.	Cat. No.	Cat. No.
Caps	White	—	16P21-UW	16P22-UW
	Black	—	16P21-UE	16P22-UE
	Brown	—	16P21-UH	16P22-UH
	Red	—	16P21-UR	16P22-UR
	Blue	—	16P21-UB	16P22-UB
	Orange	—	16S21-UO	16P22-UO
	Green	—	16S21-UG	16P22-UG
	Yellow	—	16S21-UY	16P22-UY

Note: Contact factory for availability



Related Products

To accommodate everyday use Leviton offers a variety of 16 Series accessories.
See page I-24 for more information.

Taper Nose Adapters

400A, 600VAC/DC Max — NEMA 3R Rated for Outdoor Use

The entire line of Leviton 16 Series single pole cam-type adapter cable assemblies are UL/CSA 1691 Listed and completely interoperable and interchangeable with competitive cam-type plugs and receptacles.

16 Series Cam-Type Adapters (400A, 600V) — UL/CSA 1691 Listed

16 Series, Taper Nose — Cam-Type Adapters  					
Description		Paralleling Tee F-M-M		Tapping Tee F-F-M	
	Color	Cat. No.		Cat. No.	
Max Ampacity: 400A Voltage: 600VAC/DC	White	16A21-UW		16A22-UW	
	Black	16A21-UE		16A22-UE	
	Brown	16A21-UH		16A22-UH	
	Red	16A21-UR		16A22-UR	
	Blue	16A21-UB		16A22-UB	
	Orange	16A21-UO		16A22-UO	
	Green	16A21-UG		16A22-UG	
	Yellow	16A21-UY		16A22-UY	
		3-Fer M-F-F-F	Reverse 3-Fer F-M-M-M	Double Male	Double Female
Description	Color	Cat. No.	Cat. No.	Cat. No.	Cat. No.
Max Ampacity: 400A Voltage: 600VAC/DC	White	16A23-UW	16A26-UW	16A25-UW	16A24-UW
	Black	16A23-UE	16A26-UE	16A25-UE	16A24-UE
	Brown	16A23-UH	16A26-UH	16A25-UH	16A24-UH
	Red	16A23-UR	16A26-UR	16A25-UR	16A24-UR
	Blue	16A23-UB	16A26-UB	16A25-UB	16A24-UB
	Orange	16A23-UO	16A26-UO	16A25-UO	16A24-UO
	Green	16A23-UG	16A26-UG	16A25-UG	16A24-UG
	Yellow	16A23-UY	16A26-UY	16A25-UY	16A24-UY
		Paralleling Tee F-M-M	Tapping Tee F-M-M	3-Fer M-F-F-F	Reverse 3-Fer F-M-M-M
Description	Color	Cat. No.	Cat. No.	Cat. No.	Cat. No.
Assembled Adapters Cable Size: 4/0	White	16A31-UW	16A32-UW	16A33-UW	16A36-UW
	Black	16A31-UE	16A32-UE	16A33-UE	16A36-UE
	Red	16A31-UR	16A32-UR	16A33-UR	16A36-UR
	Blue	16A31-UB	16A32-UB	16A33-UB	16A36-UB
	Green	16A31-UG	16A32-UG	16A33-UG	16A36-UG

Note: Contact factory for availability

Ampacity Table

Ampacity Ratings	
Cable Size	Ampacity
#6	105
#4	140
#2	190
#1	220
1/0	260
2/0	300
3/0	350
4/0	405

Excerpted from NEC Article 400, Table 400.5(A)(2), 90° column



16A21-UG



16A23-UE



16A24-UB



Cable Assemblies

18 Series

Ball Nose, Cam-Type Plugs

400A, 600VAC/DC Max — NEMA 3R Rated for Outdoor Use

The 18 Series Ball Nose plugs, receptacles and connectors are used by the broadcast industry in Canada, as well as the welding industry in the United States.

18 Series Cam-Type Plugs (up to 190A, 600V) — UL/CSA 1691 Listed

18 Series, Ball Nose — Cam-Type Plugs			
Description		Male Plug	Female Plug
	Color	Cat. No.	Cat. No.
Single Set Screw Termination Cable Size: #2 - 2/0 Max Ampacity: 300A Voltage: 600VAC/DC	White	18D21-UW	18D29-UW
	Black	18D21-UE	18D29-UE
	Brown	18D21-UH	18D29-UH
	Red	18D21-UR	18D29-UR
	Blue	18D21-UB	18D29-UB
	Orange	18D21-UO	18D29-UO
	Green	18D21-UG	18D29-UG
	Yellow	18D21-UY	18D29-UY
Double Set Screw Termination Cable Size: #2 - 2/0 Max Ampacity: 300A Voltage: 600VAC/DC	White	18D22-UW	18D31-UW
	Black	18D22-UE	18D31-UE
	Brown	18D22-UH	18D31-UH
	Red	18D22-UR	18D31-UR
	Blue	18D22-UB	18D31-UB
	Orange	18D22-UO	18D31-UO
	Green	18D22-UG	18D31-UG
	Yellow	18D22-UY	18D31-UY
Single Set Screw Termination Cable Size: 2/0 - 4/0 Max Ampacity: 400A Voltage: 600VAC/DC	White	18D23-UW	18D32-UW
	Black	18D23-UE	18D32-UE
	Brown	18D23-UH	18D32-UH
	Red	18D23-UR	18D32-UR
	Blue	18D23-UB	18D32-UB
	Orange	18D23-UO	18D32-UO
	Green	18D23-UG	18D32-UG
	Yellow	18D23-UY	18D32-UY
Double Set Screw Termination Cable Size: 2/0 - 4/0 Max Ampacity: 400A Voltage: 600VAC/DC	White	18D24-UW	18D33-UW
	Black	18D24-UE	18D33-UE
	Brown	18D24-UH	18D33-UH
	Red	18D24-UR	18D33-UR
	Blue	18D24-UB	18D33-UB
	Orange	18D24-UO	18D33-UO
	Green	18D24-UG	18D33-UG
	Yellow	18D24-UY	18D33-UY

Note: Contact factory for availability



Related Products

To accommodate everyday use Leviton offers a variety of 18 Series accessories.
See page I-24 for more information.

18 Series Panel Mount Receptacles (400A, 600V) — UL/CSA 1691 Listed

18 Series, Ball Nose — Panel Mount Receptacles			
		Male Plug	Female Plug
Description	Color	Cat. No.	Cat. No.
.75"L Threaded Stud Termination Cable Size: #2 - 4/0 Max Ampacity: 400A Voltage: 600VAC/DC	White	18R21-UW	18R22-UW
	Black	18R21-UE	18R22-UE
	Brown	18R21-UH	18R22-UH
	Red	18R21-UR	18R22-UR
	Blue	18R21-UB	18R22-UB
	Orange	18R21-UO	18R22-UO
	Green	18R21-UG	18R22-UG
	Yellow	18R21-UY	18R22-UY
Double Set Screw Termination Cable Size: 1/0 - 4/0 Max Ampacity: 400A Voltage: 600VAC/DC	White	18R23-UW	18R24-UW
	Black	18R23-UE	18R24-UE
	Brown	18R23-UH	18R24-UH
	Red	18R23-UR	18R24-UR
	Blue	18R23-UB	18R24-UB
	Orange	18R23-UO	18R24-UO
	Green	18R23-UG	18R24-UG
	Yellow	18R23-UY	18R24-UY

Note: Contact factory for availability



18R22-UG

18 Series Female Terminal Connectors (400A, 600V)

18 Series, Ball Nose — Female Connectors			
		Angle	Offset
Description	Color	Cat. No.	Cat. No.
Bus Bar Mount Cable Size: #2 - 4/0 Max Ampacity: 400A Voltage: 600VAC/DC	White	18F21-UW	18F22-UW
	Black	18F21-UE	18F22-UE
	Brown	18F21-UH	18F22-UH
	Red	18F21-UR	18F22-UR
	Blue	18F21-UB	18F22-UB
	Orange	18F21-UO	18F22-UO
	Green	18F21-UG	18F22-UG
	Yellow	18F21-UY	18F22-UY

Note: Contact factory for availability



18F21-UE



18P22-UE

18 Series Protective Caps

18 Series — Caps			
		Male	Female
Description	Color	Cat. No.	Cat. No.
Caps	White	18P21-UW	18P22-UW
	Black	18P21-UE	18P22-UE
	Brown	18P21-UH	18P22-UH
	Red	18P21-UR	18P22-UR
	Blue	18P21-UB	18P22-UB
	Orange	18P21-UO	18P22-UO
	Green	18P21-UG	18P22-UG
	Yellow	18P21-UY	18P22-UY

Note: Contact factory for availability

18 Series

Rhino-Hide® Single Pole | Adapters | **Industrial**



18 Series Cam-Type Adapters (400A, 600V) — UL/CSA 1691 Listed

18 Series, Ball Nose — Cam-Type Adapters

		Paralleling Tee F-M-M	Tapping Tee F-M-M		
Description	Color	Cat. No.	Cat. No.		
Max Ampacity: 400A Voltage: 600VAC/DC	White	18A21-UW	18A22-UW		
	Black	18A21-UE	18A22-UE		
	Brown	18A21-UH	18A22-UH		
	Red	18A21-UR	18A22-UR		
	Blue	18A21-UB	18A22-UB		
	Orange	18A21-UO	18A22-UO		
	Green	18A21-UG	18A22-UG		
	Yellow	18A21-UY	18A22-UY		
		3-Fer F-M-M	Double Male	Double Female	
Description	Color	Cat. No.	Cat. No.		
Max Ampacity: 400A Voltage: 600VAC/DC	White	18A23-UW	18A25-UW	18A24-UW	
	Black	18A23-UE	18A25-UE	18A24-UE	
	Brown	18A23-UH	18A25-UH	18A24-UH	
	Red	18A23-UR	18A25-UR	18A24-UR	
	Blue	18A23-UB	18A25-UB	18A24-UB	
	Orange	18A23-UO	18A25-UO	18A24-UO	
	Green	18A23-UG	18A25-UG	18A24-UG	
	Yellow	18A23-UY	18A25-UY	18A24-UY	

Note: Contact factory for availability



18A22-UE



18A23-UE



18A25-UE

Ampacity Table

Ampacity Ratings

Cable Size	Ampacity
#2	190
1/0	260
2/0	300
4/0	405

Excerpted from NEC Article 400, Table 400.5(A)(2), 90° column



Related Products

To accommodate everyday use Leviton offers a variety of 18 Series accessories.
See page I-24 for more information.

17 Series

Taper Nose, Cam-Type Plugs

690A, 600VAC/DC Max — NEMA 3R Rated for Outdoor Use

The 17 Series Taper Nose connectors withstand grueling, heavy-duty industrial use. Applications include generator test stations, water purification plants, electrochemical machining equipment and other general industrial uses.

17 Series Cam-Type Plugs (up to 690A, 600V)

17 Series, Taper Nose — Cam-Type Plugs			
		Male Plug	Female Plug
Description	Color	Cat. No.	Cat. No.
Double Set Screw Termination	White	17D22-W	17D24-W
Cable Size: 350-500MCM	Black	17D22-E	17D24-E
Max Ampacity: 690A	Brown	17D22-H	17D24-H
Voltage: 600V	Red	17D22-R	17D24-R
Neoprene™ Sleeve	Blue	17D22-B	17D24-B
Detachable	Orange	17D22-O	17D24-O
	Green	17D22-G	17D24-G
	Yellow	17D22-Y	17D24-Y
Crimp Tube Termination	White	17V23-W	17V26-W
Cable Size: 500-750MCM	Black	17V23-E	17V26-E
Max Ampacity: 690A	Brown	17V23-H	17V26-H
Voltage: 600V	Red	17V23-R	17V26-R
Neoprene™ Sleeve	Blue	17V23-B	17V26-B
Detachable	Orange	17V23-O	17V26-O
	Green	17V23-G	17V26-G
	Yellow	17V23-Y	17V26-Y

Note: Contact factory for availability



17 Series Panel Mount Receptacles (690A, 600V)

17 Series, Taper Nose — Panel Mount Receptacle					
		Male 90°	Female 90°	Male 30°	Female 30°
Description	Color	Cat. No.	Cat. No.	Cat. No.	Cat. No.
Threaded Stud Termination	White	17R21-W	17R22-W	17R23-W	17R24-W
Cable Size: 250-750MCM	Black	17R21-E	17R22-E	17R23-E	17R24-E
Max Ampacity: 690A	Brown	17R21-H	17R22-H	17R23-H	17R24-H
Voltage: 600V	Red	17R21-R	17R22-R	17R23-R	17R24-R
	Blue	17R21-B	17R22-B	17R23-B	17R24-B
	Orange	17R21-O	17R22-O	17R23-O	17R24-O
	Green	17R21-G	17R22-G	17R23-G	17R24-G
	Yellow	17R21-Y	17R22-Y	17R23-Y	17R24-Y

Note: Contact factory for availability



Related Products



To accommodate everyday use Leviton offers a variety of 17 Series accessories.
See page I-24 for more information.

17 Series

Rhino-Hide® Single Pole | Covers and Caps | **Industrial**



17 Series Protective Covers and Caps

17 Series — Covers  				
		Male/Female	Male	Female
Description	Color	Cat. No.	Cat. No.	Cat. No.
NEMA 3R Enclosure	White	17S31-W	—	—
	Black	17S31-E	—	—
	Brown	17S31-H	—	—
	Red	17S31-R	—	—
	Blue	17S31-B	—	—
	Orange	17S31-O	—	—
	Green	17S31-G	—	—
	Yellow	17S31-Y	—	—

17 Series — Caps				
		Male/Female	Male	Female
Description	Color	Cat. No.	Cat. No.	Cat. No.
Caps	White	—	17P21-W	17P22-W
	Black	—	17P21-E	17P22-E
	Brown	—	17P21-H	17P22-H
	Red	—	17P21-R	17P22-R
	Blue	—	17P21-B	17P22-B
	Orange	—	17P21-O	17P22-O
	Green	—	17P21-G	17P22-G
	Yellow	—	17P21-Y	17P22-Y

Note: Contact factory for availability



17S31-R



17P21-O

Ampacity Table

Ampacity Ratings	
Cable Size	Ampacity
250	455
350	570
500	700
750	885

Excerpted from NEC Article 400, Table 400.5(A)(2), 90° column



Related Products

To accommodate everyday use Leviton offers a variety of 17 Series accessories.
See page I-24 for more information.

19 Series

Ball Nose, Cam-Type Plugs

690A, 600VAC/DC Max — NEMA 3R Rated for Outdoor Use

The 19 Series Ball Nose connectors are rated up to 690 Amps and are designed for heavy-duty industrial applications.

19 Series Cam-Type Plugs (up to 690A, 600V)

19 Series, Ball Nose — Cam-Type Plugs			
		Male Plug	Female Plug
Description	Color	Cat. No.	Cat. No.
Double Set Screw Termination	White	19D22-W	19D24-W
Cable Size: 350-500MCM	Black	19D22-E	19D24-E
Max Ampacity: 690A	Brown	19D22-H	19D24-H
Voltage: 600V	Red	19D22-R	19D24-R
	Blue	19D22-B	19D24-B
	Orange	19D22-O	19D24-O
	Green	19D22-G	19D24-G
	Yellow	19D22-Y	19D24-Y

Note: Contact factory for availability



19D22-G



19D24-B

19 Series Panel Mount Receptacles (690A, 600V)

19 Series, Ball Nose — Panel Mount Receptacles			
		Male 90°	Female 90°
Description	Color	Cat. No.	Cat. No.
1.00" L Threaded Stud Termination	White	19R21-W	19R22-W
Cable Size: 250-750MCM	Black	19R21-E	19R22-E
Max Ampacity: 690A	Brown	19R21-H	19R22-H
Voltage: 600V	Red	19R21-R	19R22-R
	Blue	19R21-B	19R22-B
	Orange	19R21-O	19R22-O
	Green	19R21-G	19R22-G
	Yellow	19R21-Y	19R22-Y

Note: Contact factory for availability



19P21-E

19 Series Protective Caps

19 Series — Caps			
		Male	Female
Description	Color	Cat. No.	Cat. No.
Caps	White	19P21-W	19P22-W
	Black	19P21-E	19P22-E
	Brown	19P21-H	19P22-H
	Red	19P21-R	19P22-R
	Blue	19P21-B	19P22-B
	Orange	19P21-O	19P22-O
	Green	19P21-G	19P22-G
	Yellow	19P21-Y	19P22-Y

Note: Contact factory for availability

Ampacity Table

Ampacity Ratings	
Cable Size	Ampacity
250	455
350	570
500	700
750	885



Related Products

To accommodate everyday use Leviton offers a variety of 19 Series accessories.
See page I-24 for more information.

22 Series

Latching Ball Nose, Cam-Type Plugs

690A, 600VAC/DC Max

Leviton's cam-type positive latching connectors and receptacles are the standard used by Navy bases and shipyards in supplying 3-phase power to ships at dockside. These heavy duty, completely insulated connectors are vibration resistant so they will not loosen — ensuring high conductivity and maximum efficiency. Contacts can be retrofitted to existing locations and power distribution systems.

22 Series Cam-Type Plugs (up to 690A, 600V)

22 Series, Latching Ball Nose — Cam-Type Plugs			
		Male Plug	Female Plug
Description	Color	Cat. No.	Cat. No.
Crimp Tube Termination	White	22L21-W	22L24-W
Cable Size: 250-350MCM	Black	22L21-E	22L24-E
Max Ampacity: 570A	Brown	22L21-H	22L24-H
Voltage: 600V	Red	22L21-R	22L24-R
Neoprene™ Sleeve	Blue	22L21-B	22L24-B
	Orange	22L21-O	22L24-O
	Green	22L21-G	22L24-G
	Yellow	22L21-Y	22L24-Y
Crimp Tube Termination	White	22L22-W	22L25-W
Cable Size: 350-500MCM	Black	22L22-E	22L25-E
Max Ampacity: 690A	Brown	22L22-H	22L25-H
Voltage: 600V	Red	22L22-R	22L25-R
Neoprene™ Sleeve	Blue	22L22-B	22L25-B
	Orange	22L22-O	22L25-O
	Green	22L22-G	22L25-G
	Yellow	22L22-Y	22L25-Y
Crimp Tube Termination	White	22L22-SW	22L25-SW
Cable Size: 350-500MCM	Black	22L22-SE	22L25-SE
Max Ampacity: 690A	Brown	22L22-SH	22L25-SH
Voltage: 600V	Red	22L22-SR	22L25-SR
TPV Sleeve	Blue	22L22-SB	22L25-SB
	Orange	22L22-SO	22L25-SO
	Green	22L22-SG	22L25-SG
	Yellow	22L22-SY	22L25-SY
Crimp Tube Termination	White	22L23-W	22L26-W
Cable Size: 500-750MCM	Black	22L23-E	22L26-E
Max Ampacity: 690A	Brown	22L23-H	22L26-H
Voltage: 600V	Red	22L23-R	22L26-R
Neoprene™ Sleeve	Blue	22L23-B	22L26-B
	Orange	22L23-O	22L26-O
	Green	22L23-G	22L26-G
	Yellow	22L23-Y	22L26-Y

Note: Contact factory for availability



22L21-R



22L25-E



22L25-SR



22L23-E



Related Products

To accommodate everyday use Leviton offers a variety of 22 Series accessories.
See page I-24 for more information.

22 Series Panel Mount Receptacles (690A, 600V)



22 Series, Latching Ball Nose — Panel Mount Receptacles					
		Male 90°	Female 90°	Male 30°	Female 30°
Description	Color	Cat. No.	Cat. No.	Cat. No.	Cat. No.
1.00"L Threaded Stud Termination	White	22R21-W	22R22-W	22R23-W	22R24-W
Cable Size: 250-750MCM	Black	22R21-E	22R22-E	22R23-E	22R24-E
Max Ampacity: 690A	Brown	22R21-H	22R22-H	22R23-H	22R24-H
Voltage: 600V	Red	22R21-R	22R22-R	22R23-R	22R24-R
	Blue	22R21-B	22R22-B	22R23-B	22R24-B
	Orange	22R21-O	22R22-O	22R23-O	22R24-O
	Green	22R21-G	22R22-G	22R23-G	22R24-G
	Yellow	22R21-Y	22R22-Y	22R23-Y	22R24-Y

		Female 15°	With Microswitch
Description	Color	Cat. No.	Cat. No.
1.00"L Threaded Stud Termination	White	22R26-W	22R28-W
Cable Size: 250-750MCM	Black	22R26-E	22R28-E
Max Ampacity: 690A	Red	22R26-R	22R28-R
Voltage: 600V			

Note: Contact factory for availability



22 Series Protective Caps

22 Series — Caps  			
		Male	Female
Description	Color	Cat. No.	Cat. No.
Caps	White	22P21-W	22P22-W
	Black	22P21-E	22P22-E
	Brown	22P21-H	22P22-H
	Red	22P21-R	22P22-R
	Blue	22P21-B	22P22-B
	Orange	22P21-O	22P22-O
	Green	22P21-G	22P22-G
	Yellow	22P21-Y	22P22-Y

Note: Contact factory for availability



Ampacity Table

Ampacity Ratings	
Cable Size	Ampacity
250	455
350	570
500	700
750	885

Excerpted from NEC Article 400, Table 400.5(A)(2), 90° column

23 Series

Rhino-Hide® Single Pole | Plugs | Receptacles | **Industrial**



23 Series

Latching Taper Nose, Cam-Type Plugs

690A, 600VAC/DC Max

23 Series Cam-Type Plugs (up to 690A, 600V)

23 Series, Latching Taper Nose — Cam-Type Plugs

		Male Plug	Female Plug
Description	Color	Cat. No.	Cat. No.
Crimp Tube Termination Cable Size: 350-500MCM Max Ampacity: 690A Voltage: 600V Neoprene™ Sleeve	White	23L22-W	23L25-W
	Black	23L22-E	23L25-E
	Brown	23L22-H	23L25-H
	Red	23L22-R	23L25-R
	Blue	23L22-B	23L25-B
	Orange	23L22-O	23L25-O
	Green	23L22-G	23L25-G
	Yellow	23L22-Y	23L25-Y
Crimp Tube Termination Cable Size: 500-750MCM Max Ampacity: 690A Voltage: 600V Neoprene™ Sleeve	White	23L23-W	23L26-W
	Black	23L23-E	23L26-E
	Brown	23L23-H	23L26-H
	Red	23L23-R	23L26-R
	Blue	23L23-B	23L26-B
	Orange	23L23-O	23L26-O
	Green	23L23-G	23L26-G
	Yellow	23L23-Y	23L26-Y

Note: Contact factory for availability



23L25-G



23L23-E



23L26-R

23 Series Panel Mount Receptacles (690A, 600V)

23 Series, Latching Taper Nose — Panel Mount Receptacles

		Male 30°	Female 30°
Description	Color	Cat. No.	Cat. No.
1.00"L Threaded Stud Termination Cable Size: 250-750MCM Max Ampacity: 690A Voltage: 600V	White	23R23-W	23R24-W
	Black	23R23-E	23R24-E
	Brown	23R23-H	23R24-H
	Red	23R23-R	23R24-R
	Blue	23R23-B	23R24-B
	Orange	23R23-O	23R24-O
	Green	23R23-G	23R24-G
	Yellow	23R23-Y	23R24-Y



Note: Contact factory for availability



Related Products

To accommodate everyday use Leviton offers a variety of 23 Series accessories.
See page I-24 for more information.

23 Series Protective Caps

23 Series — Caps  			
		Male	Female
Description	Color	Cat. No.	Cat. No.
Caps	White	23P21-W	23P22-W
	Black	23P21-E	23P22-E
	Brown	23P21-H	23P22-H
	Red	23P21-R	23P22-R
	Blue	23P21-B	23P22-B
	Orange	23P21-O	23P22-O
	Green	23P21-G	23P22-G
	Yellow	23P21-Y	23P22-Y

Note: Contact factory for availability

Ampacity Table

Ampacity Ratings	
Cable Size	Ampacity
250	455
350	570
500	700
750	885

Excerpted from NEC Article 400, Table 400.5(A)(2), 90° column

Tools and Replacement Parts for 15-23 Series

Rhino-Hide® Single Pole | **Industrial**



Assembly Tools & Replacement Parts

"Com-A-Long" Assembly Tool 15 Series

Description	Cat. No.
For Female Plug	15CLF-U
For Male Plug	15CLM-U

"Com-A-Long" Assembly Tool 16, 18 Series

Description	Cat. No.
For Female Plug	16CLF-U
For Male Plug	16CLM-U

Copper Shims (10 Per Package)

Description	Cat. No.
15 Series	A0006
16 Series & 18 Series	A0004

Strain-Relief Wire (10 Per Package)

Description	Cat. No.
15 Series	A0007
16 Series & 18 Series	A0003

"Com-A-Long" Assembly Tool 17, 19, 22, 23 Series

Description	Cat. No.
For Female Plug	17CLF
For Male Plug	17CLM

Set Screws (10 Per Package)

Description	Cat. No.
15 Series	A0001
16 Series & 18 Series	A0002

Plastic Screws (10 Per Package)

Description	Cat. No.
16 Series & 18 Series	A0010
15 Series	A0011

49 Series

Rhino-Hide® 49 Series devices can be installed on both existing silicon-controlled rectifiers (SCR's) and generator stations or on new oil and gas rig construction. These devices are used by SCR drive manufacturers and top drive manufacturers to distribute power from the SCR to mud pumps and top drives.

Features and Benefits

- Ideal for replacement, these connectors mate with other manufacturers' high-amperage single pole connectors and receptacles for fast, easy change-out
- UV stable, polyolefin-based Santoprene™ TPV housings resist fading and cracking for longer service life
- Contacts machined from high conductivity copper alloy and silver-plated for corrosion resistance and superior conductivity
- Color-coded, metal, in-line coupler prevents unauthorized separation of connectors
- Male contact silver and gold plated for superior performance
- Color-coded connector housing for quick visual identification of circuit and phase connections

Male and Female Plugs

49 Series Male and Female Mated

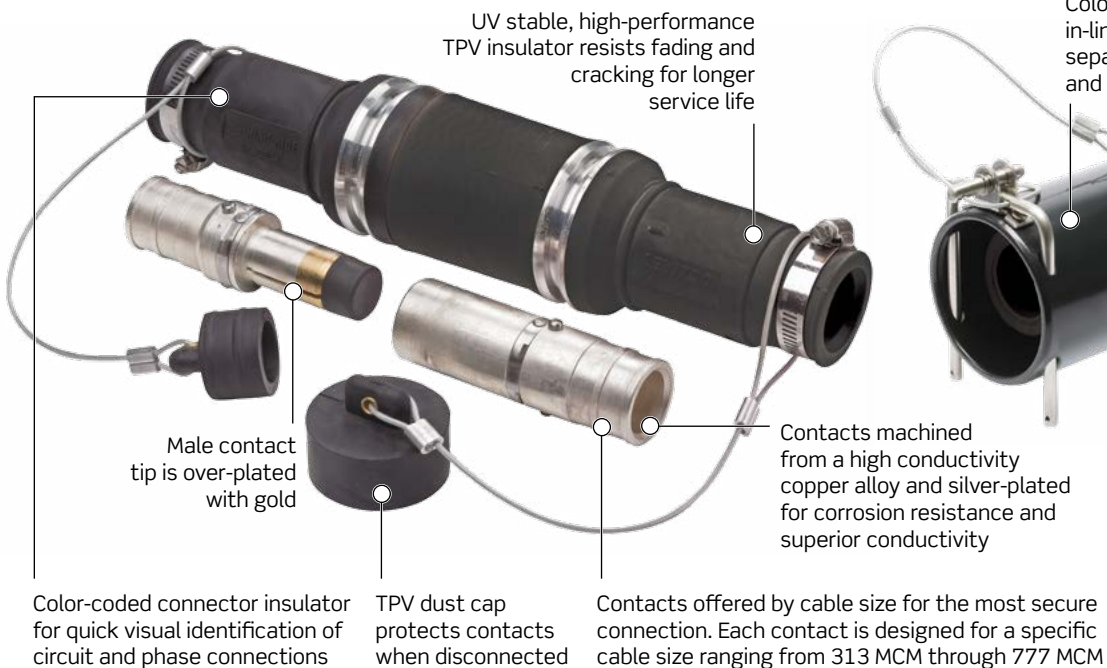

Coupler



Color Choices Rhino-Hide® Cam-Type devices are offered in a wide range of colors. To order colors, add suffix to Cat. No.

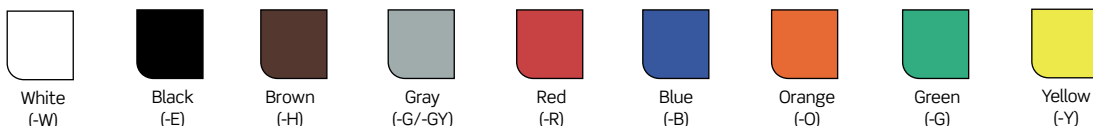

Panel Mounted Receptacles

49FR Series

With thermal stability ranging from -60°C to 135°C (-76°F to 275°F) the high-performance TPV bus bar insulator resists cracking for longer service life

Ideal for replacement; receptacles mate with other manufacturers' high-amperage single pole plugs for fast, easy change-out

Receptacles deliver up to 1,135 Amps continuous duty

Captive stainless steel clevis bracket

Cast aluminum powder-coated receptacle housing is color-coded for quick visual identification of circuit and phase connections

Detent pin allows clevis pin to stay secure in either open or closed position

TPV cap prevents contamination when receptacle is not in use

"X" version receptacle housings feature a 45° angle stainless steel clevis pin that permits ganging of multiple receptacles in very close proximity to each other (as close as ¼") for installation on smaller panels

Stainless steel clevis bracket accepts industry standard lockout

Available colors include: Black, White, Red, Blue, Green, Yellow, Orange, Brown, Purple and Gray. For additional colors, consult factory.

Color-coding the devices minimizes errors due to mis-wiring and saves time during assembly and troubleshooting, especially on dusty and dirty oil rigs.



Male and Female Cable Connectors

Cable Sizes 313 MCM through 777 MCM, 1135A Max

49 Series Devices — Male Plugs						
Max Ampacity	636A	796A	898A	1009A	1135A	
Conductor Size	313 MCM	444 MCM	535 MCM	646 MCM	777 MCM	Replacement Sleeve
Color	Cat. No.	Cat. No.	Cat. No.	Cat. No.	Cat. No.	Cat. No.
White	49M31-W	49M44-W	49M53-W	49M64-W	49M77-W	49MSL-W
Black	49M31-E	49M44-E	49M53-E	49M64-E	49M77-E	49MSL-E
Brown	49M31-H	49M44-H	49M53-H	49M64-H	49M77-H	49MSL-H
Red	49M31-R	49M44-R	49M53-R	49M64-R	49M77-R	49MSL-R
Blue	49M31-B	49M44-B	49M53-B	49M64-B	49M77-B	49MSL-B
Orange	49M31-O	49M44-O	49M53-O	49M64-O	49M77-O	49MSL-O
Green	49M31-G	49M44-G	49M53-G	49M64-G	49M77-G	49MSL-G
Yellow	49M31-Y	49M44-Y	49M53-Y	49M64-Y	49M77-Y	49MSL-Y
Purple	49M31-P	49M44-P	49M53-P	49M64-P	49M77-P	49MSL-P
Gray	49M31-GY	49M44-GY	49M53-GY	49M64-GY	49M77-GY	49MSL-GY
	Cat. No.	Cat. No.	Cat. No.	Cat. No.	Cat. No.	Cat. No.
Replacement Contact	49M31-C	49M44-C	49M53-C	49M64-C	49M77-C	—

49 Series Devices — Female Plugs						
Max Ampacity	636A	796A	898A	1009A	1135A	
Conductor Size	313 MCM	444 MCM	535 MCM	646 MCM	777 MCM	Replacement Sleeve
Color	Cat. No.	Cat. No.	Cat. No.	Cat. No.	Cat. No.	Cat. No.
White	49F31-W	49F44-W	49F53-W	49F64-W	49F77-W	49FSL-W
Black	49F31-E	49F44-E	49F53-E	49F64-E	49F77-E	49FSL-E
Brown	49F31-H	49F44-H	49F53-H	49F64-H	49F77-H	49FSL-H
Red	49F31-R	49F44-R	49F53-R	49F64-R	49F77-R	49FSL-R
Blue	49F31-B	49F44-B	49F53-B	49F64-B	49F77-B	49FSL-B
Orange	49F31-O	49F44-O	49F53-O	49F64-O	49F77-O	49FSL-O
Green	49F31-G	49F44-G	49F53-G	49F64-G	49F77-G	49FSL-G
Yellow	49F31-Y	49F44-Y	49F53-Y	49F64-Y	49F77-Y	49FSL-Y
Purple	49F31-P	49F44-P	49F53-P	49F64-P	49F77-P	49FSL-P
Gray	49F31-GY	49F44-GY	49F53-GY	49F64-GY	49F77-GY	49FSL-GY
	Cat. No.	Cat. No.	Cat. No.	Cat. No.	Cat. No.	Cat. No.
Replacement Contact	49F31-C	49F44-C	49F53-C	49F64-C	49F77-C	—

Note: Contact factory for availability



Complete Male Connector & Contact
49M77-R



Complete Female Connector & Contact
49F77-G
Contacts are for copper cable only

Panel Mount Receptacles

Rhino-Hide® receptacles include a bus bar with male or female contact inserted into a TPV insulator, which is protected by a powder coated metal housing and TPV dust cap. Bus bars are available with single or double holes and each is compatible with the full cable range: 313 MCM to 777 MCM. Choose a male bus bar for the power side of the circuit or a female bus bar for the motor load side of the circuit. "X" Version receptacle housings feature a 45° angle stainless steel clevis pin that permits ganging of multiple receptacles (as close as 1/4" away from one another).

49 Series Panel Mount Receptacles (1135A, 1000V)

49 Series — Complete Male and Complete Female Panel Mount Receptacles					
		Complete Male Receptacle		Complete Female Receptacle	
		Single Hole Bus Bar	Double Hole Bus Bar	Single Hole Bus Bar	Double Hole Bus Bar
Description	Color	Cat. No.	Cat. No.	Cat. No.	Cat. No.
Receptacle Spacing:	White	49MR1-CW	49MR2-CW	49FR1-CW	49FR2-CW
¼" Horizontally,	Black	49MR1-CE	49MR2-CE	49FR1-CE	49FR2-CE
3 ¼" Vertically	Brown	49MR1-CH	49MR2-CH	49FR1-CH	49FR2-CH
Cable Size: 313-777MCM	Red	49MR1-CR	49MR2-CR	49FR1-CR	49FR2-CR
Max Ampacity: 1135A	Blue	49MR1-CB	49MR2-CB	49FR1-CB	49FR2-CB
Voltage: 1000V	Orange	49MR1-CO	49MR2-CO	49FR1-CO	49FR2-CO
	Green	49MR1-CG	49MR2-CG	49FR1-CG	49FR2-CG
	Yellow	49MR1-CY	49MR2-CY	49FR1-CY	49FR2-CY
	Purple	49MR1-CP	49MR2-CP	49FR1-CP	49FR2-CP
	Gray	49MR1-CGY	49MR2-CGY	49FR1-CGY	49FR2-CGY

		Complete Male Receptacle		Complete Female Receptacle	
		Single Hole Bus Bar	Double Hole Bus Bar	Single Hole Bus Bar	Double Hole Bus Bar
Description	Color	Cat. No.	Cat. No.	Cat. No.	Cat. No.
Receptacle Spacing:	White	49MR1-XW	49MR2-XW	49FR1-XW	49FR2-XW
¼" Horizontally and	Black	49MR1-XE	49MR2-XE	49FR1-XE	49FR2-XE
Vertically	Brown	49MR1-XH	49MR2-XH	49FR1-XH	49FR2-XH
Cable Size: 313-777MCM	Red	49MR1-XR	49MR2-XR	49FR1-XR	49FR2-XR
Max Ampacity: 1135A	Blue	49MR1-XB	49MR2-XB	49FR1-XB	49FR2-XB
Voltage: 1000V	Orange	49MR1-XO	49MR2-XO	49FR1-XO	49FR2-XO
	Green	49MR1-XG	49MR2-XG	49FR1-XG	49FR2-XG
	Yellow	49MR1-XY	49MR2-XY	49FR1-XY	49FR2-XY
	Purple	49MR1-XP	49MR2-XP	49FR1-XP	49FR2-XP
	Gray	49MR1-XGY	49MR2-XGY	49FR1-XGY	49FR2-XGY

Note: Contact factory for availability



49MR Series



Single Hole and Double Hole Bus Bar Terminations



49MR-X Series



Coupler



Clevis Pin



Dust Cover Cap

Accessories and Replacement Parts

49 Series — Connector Accessories and Replacement Parts			
For Plugs			
Description	Color	Material	Cat. No.
Clevis Pin for In-Line Connector Coupler	Silver	Stainless Steel	49PNR
Male Dust Cap	Black	High-Performance TPV	49DSM
Female Dust Cap	Black	High-Performance TPV	49DSF
In-line Coupler	White	Powder-coated aluminum	49COP-W
In-line Coupler	Black	Powder-coated aluminum	49COP-E
In-line Coupler	Brown	Powder-coated aluminum	49COP-H
In-line Coupler	Red	Powder-coated aluminum	49COP-R
In-line Coupler	Blue	Powder-coated aluminum	49COP-B
In-line Coupler	Orange	Powder-coated aluminum	49COP-O
In-line Coupler	Green	Powder-coated aluminum	49COP-G
In-line Coupler	Yellow	Powder-coated aluminum	49COP-Y
For Panel Mounted Receptacles			
Description	Color	Material	Cat. No.
Clevis Pin for Panel Mount Receptacle	Silver	Stainless Steel	49PNR*
Dust Cover Cap for Male or Female Receptacle	Black	High-Performance TPV	49DSR
Receptacle Housing Gasket	Black	Rubber	49GAS
Locking Ground Pin	—	Brass	15GND-M
Locking Ground Plug (Female)	Green	TPV/Brass	15D22-G

*Does not fit "X" Version.
Note: Contact factory for availability

Rhino-Hide® with Ground Pin

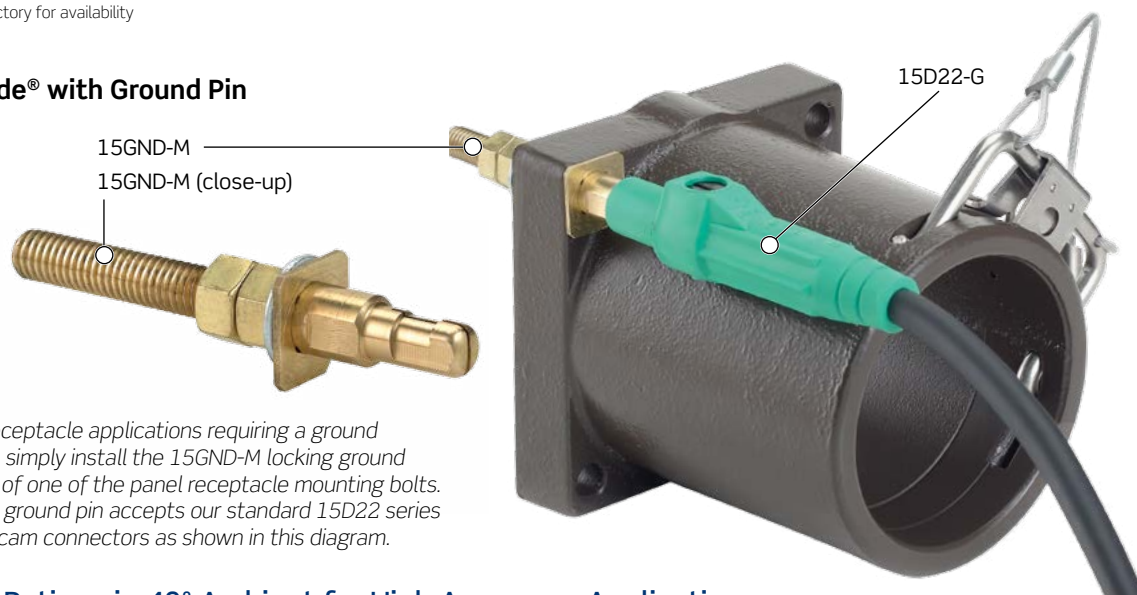

For panel receptacle applications requiring a ground connection, simply install the 15GND-M locking ground pin in place of one of the panel receptacle mounting bolts. The locking ground pin accepts our standard 15D22 series single pole cam connectors as shown in this diagram.

Ampacity Ratings in 40° Ambient for High Amperage Applications

Ampacity Ratings		
Cable Size	90° C (194° F)	125° C (257° F)
313 MCM	513	636
444 MCM	642	796
535 MCM	724	898
646 MCM	814	1009
777 MCM	916	1135

Portable Outlet Boxes, Cover Plates and Wire Mesh Grips

Ideal for Temporary Power Applications

Portable Electrical Outlet Boxes from Leviton are the perfect solution for creating OSHA and NEC Compliant portable power pendants and stringers for temporary power applications.

Features and Benefits

Portable Outlet Boxes

- Available in single-gang and two-gang sizes
- Extremely resistant to heat and harsh chemicals
- Feed-thru and pendant styles available

Cover Plates

- Available in a variety of styles
- Provide superior impact resistance
- Flip-lid versions are rated NEMA Type 3R

Portable Outlet Box and Cover Plate Group



Portable Outlet Boxes — Single Gang



3059-1E



3059F-1E



3099F-1E



3099F-2E

Single Gang Portable Outlet Boxes

	Cable Diameter	Black	Yellow	Dimensions A	Dimensions B	Dimensions C
Description		Cat. No.	Cat. No.			
Standard Depth, Pendant Style*	0.230" – 0.546"	3059-1E	3059-1Y	3.375"	3.900"	2.500"
Standard Depth, Feed-Thru Style*	0.230" – 0.546"	3059F-1E	3059F-1Y	3.375"	3.900"	2.500"
Extra Deep, Pendant Style	0.230" – 0.546"	3099-1E	3099-1Y	4.375"	3.900"	2.500"
Extra Deep, Feed-Thru Style	0.230" – 0.546"	3099F-1E	3099F-1Y	4.375"	3.900"	2.500"
Extra Deep, Pendant Style	0.590" – 1.000"	3099-2E	3099-2Y	4.375"	3.900"	2.500"
Extra Deep, Feed-Thru Style	0.590" – 1.000"	3099F-2E	3099F-2Y	4.375"	3.900"	2.500"

*GFCI devices and deep body receptacles are not compatible (must use extra deep version)

Cover Plates — Single Gang



3054



3051



3056



3060



3061



3052



3057



3055



3058

Cover Plates — Single Gang

	Black	Yellow
Description	Cat. No.	Cat. No.
Blank	3054-E	3054-Y
Duplex	3051-E	3051-Y
Duplex with weather-resistant flip lid*	3056-E	3056-Y
GFCI	3060-E	3060-Y
GFCI with weather-resistant flip lid*~	3061-E	3061-Y
1.39" diameter	3052-E	3052-Y
1.39" diameter Single receptacle cover plate with weather-resistant flip lid*	3057-E	3057-Y
1.56" diameter	3055-E	3055-Y
1.56" diameter Single receptacle cover plate with weather-resistant flip lid*	3058-E	3058-Y

*NEMA Type 3R Rated.

~Tamper Resistant GFCI Devices not compatible

Portable Outlet Boxes and Covers

Single Gang | **Industrial**



Dimensions for Single Gang Portable Outlet Boxes and Covers

Single Gang Box

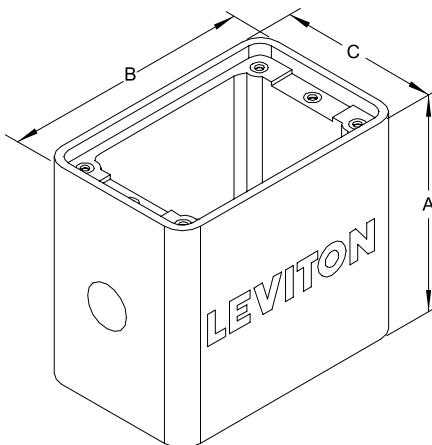

Single Gang GFCI Cover

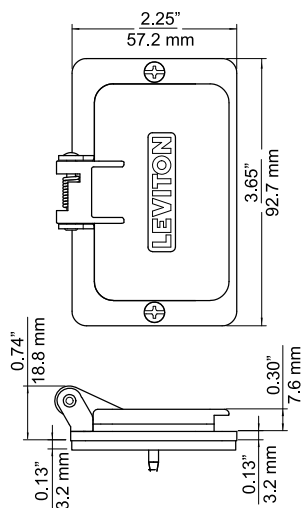

Single Gang GFCI Plate

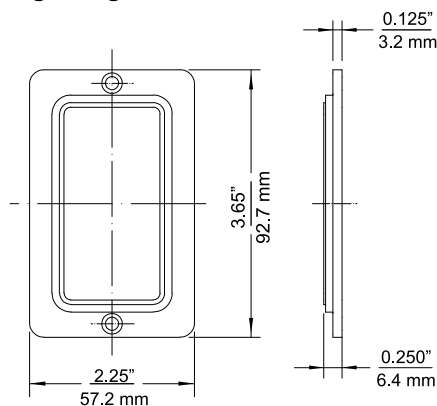

Single Gang Cover

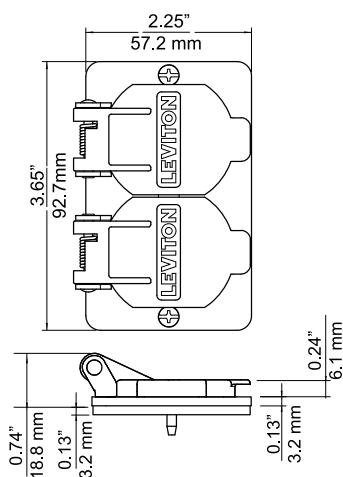

Single Gang Duplex Cover
Typical for Receptacle Plates

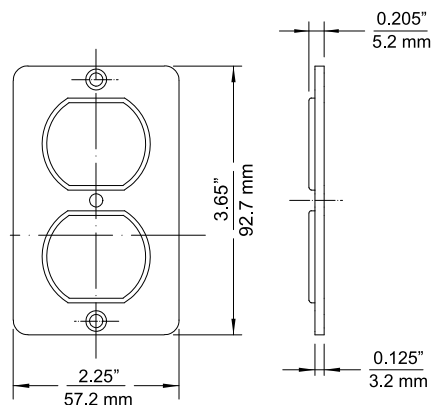

Portable Outlet Boxes — 2-Gang



3200-02Y



3300-02Y

2-Gang Portable Outlet Boxes

	Cable Diameter	Black	Yellow	Dimensions A	Dimensions B	Dimensions C	Dimensions D
Description		Cat. No.	Cat. No.				
Standard Depth, Pendant Style	0.590" - 1.000"	3200-2E	3200-2Y	5.100"	5.655"	4.655"	—
Standard Depth, Feed-Thru Style	0.590" - 1.000"	3200F-2E	3200F-2Y	5.100"	5.655"	4.655"	—
Angled Depth, Pendant Style	0.590" - 1.000"	3300-2E	3300-2Y	4.300"	5.655"	4.655"	3.200"

Cover Plates — 2-Gang



3265



3260



3260W



3251



3251W



3241



3241W



3262



3262W



3261



3261W



3263



3263W

Cover Plates

	Black	Yellow
Description	Cat. No.	Cat. No.
Blank	3265-E	3265-Y
2 - Duplex	3260-E	3260-Y
2 - Duplex with weather-resistant flip lid*	3260W-E	3260W-Y
2 - GFCI	3251-E	3251-Y
2 - GFCI with weather-resistant flip lid*~	3251W-E	3251W-Y
1 - GFCI, 1 - Blank	3241-E	3241-Y
1 - GFCI with weather-resistant flip lid, 1 - Blank*~	3241W-E	3241W-Y
1 - 1.56" diameter Single receptacle, 1 - Duplex receptacle	3262-E	3262-Y
1 - 1.56" diameter Single receptacle with weather-resistant flip lid, 1 - Duplex receptacle cover plate with weather-resistant flip lid	3262W-E	3262W-Y
1 - 1.56" diameter Single receptacle, 1 - Blank cover plate	3261-E	3261-Y
1 - 1.56" diameter Single receptacle with weather-resistant flip lid, 1 - Blank cover plate~	3261W-E	3261W-Y
2 - 1.56" diameter Single receptacle cover plate	3263-E	3263-Y
2 - 1.56" diameter Single receptacle cover plate with weather-resistant flip lid~	3263W-E	3263W-Y

*NEMA Type 3R Rated.

~Tamper-Resistant GFCI Devices may not be compatible — consult factory for details

Portable Outlet Boxes and Covers

2-Gang | Industrial



Dimensions for Two-Gang Portable Outlet Boxes and Covers

Two Gang Cover

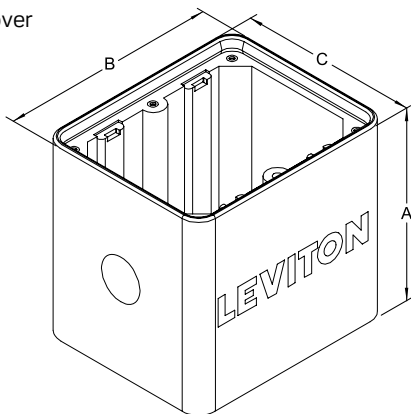

Angle Box

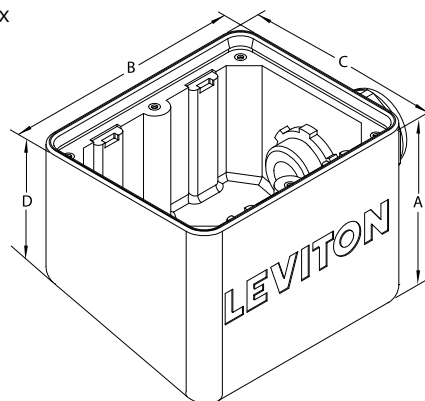

2G Decora® Cover

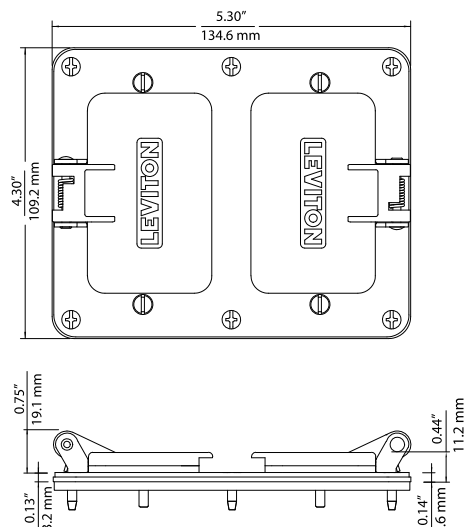

Two-Gang Duplex Plate
Typical for Receptacle Plates

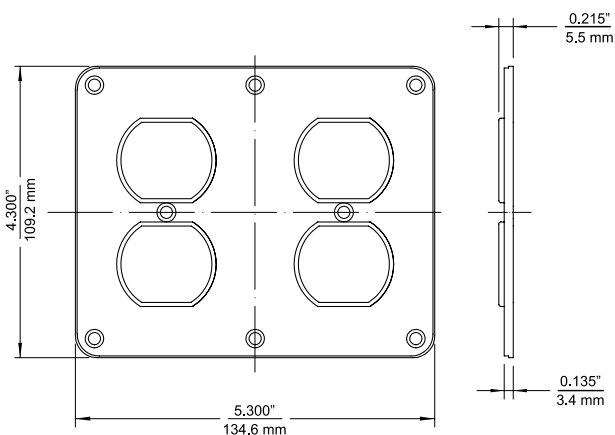

2G Combo Cover
Receptacle and Duplex

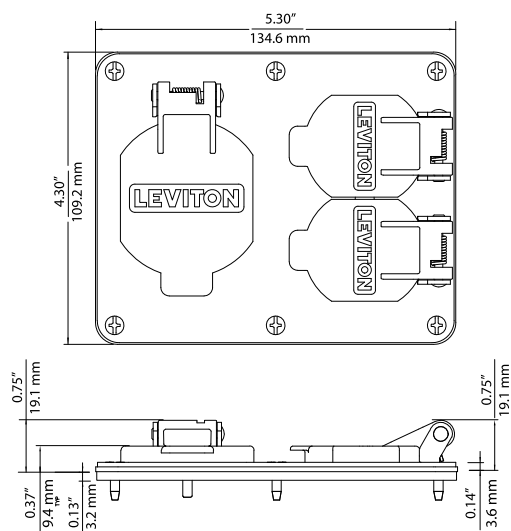

Two-Gang GFCI Plate

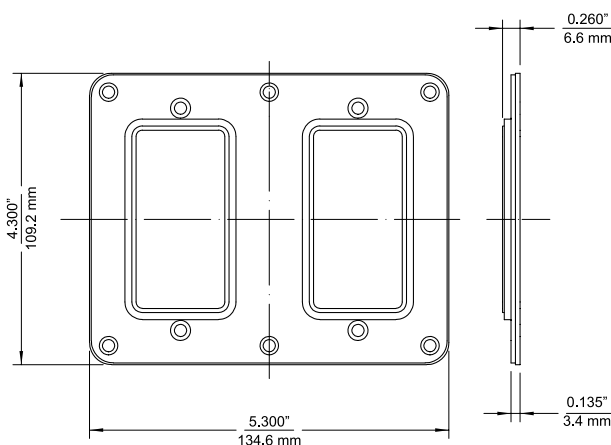

Wire Mesh Strain-Relief Grips for Portable Outlet Boxes

Features and Benefits

- Available in multiple cable diameter ranges
- Stainless steel construction provides increased durability
- Long neck body style for improved grip

Wire Mesh Strain-Relief Grip — for use with Portable Outlet Boxes 3099-1 & 3059-1

Description	Cat. No.	Cable Range	Length "M"	N.P.T. Fitting Size	Form Size	Length "A"	Length "B"
Stainless Steel Wire Mesh Strain-Relief Grip	L7278	0.31 - 0.38" / 7.9 - 9.5mm	4.5" ± 0.5 / 114.3mm ± 12.7	1/2"	2"	0.5" / 12.7mm	0.75" / 19.1mm
	L7279	0.38 - 0.44" / 9.5 - 11.1mm	5.5" ± 0.5 / 139.7mm ± 12.7				
	L7280	0.44 - 0.50" / 11.1 - 12.7mm	6.5" ± 0.5 / 165.1mm ± 12.7				
	L7281	0.50 - 0.56" / 12.7 - 14.3mm	6.75" ± 0.5 / 171.5mm ± 12.7				
	L7282	0.56 - 0.63" / 14.3 - 15.9mm	6.75" ± 0.5 / 171.5mm ± 12.7				

Wire Mesh Strain-Relief Grip — for use with Portable Outlet Boxes 3099-2, 3059-2 & 3200-2

Description	Cat. No.	Cable Range	Length "M"	N.P.T. Fitting Size	Form Size	Length "A"	Length "B"
Stainless Steel Wire Mesh Strain-Relief Grip	L7283	0.56 - 0.69" / 14.3 - 17.5mm	9.0" ± 1.0 / 228.6mm ± 25.4	1"	4"	0.66" / 16.8mm	1.03" / 26.2mm
	L7284	0.63 - 0.75" / 15.9 - 19.1mm	9.5" ± 1.0 / 241.3mm ± 25.4				
	L7285	0.75 - 0.88" / 19.1 - 22.2mm	9.5" ± 1.0 / 241.3mm ± 25.4				
	L7286	0.81 - 0.94" / 20.6 - 23.8mm	8.75" ± 1.0 / 222.3mm ± 25.4				
	L7287	0.88 - 1.0" / 22.2 - 25.4mm	8.75" ± 1.0 / 222.3mm ± 25.4				

Note: All portable outlet boxes include a standard strain-relief

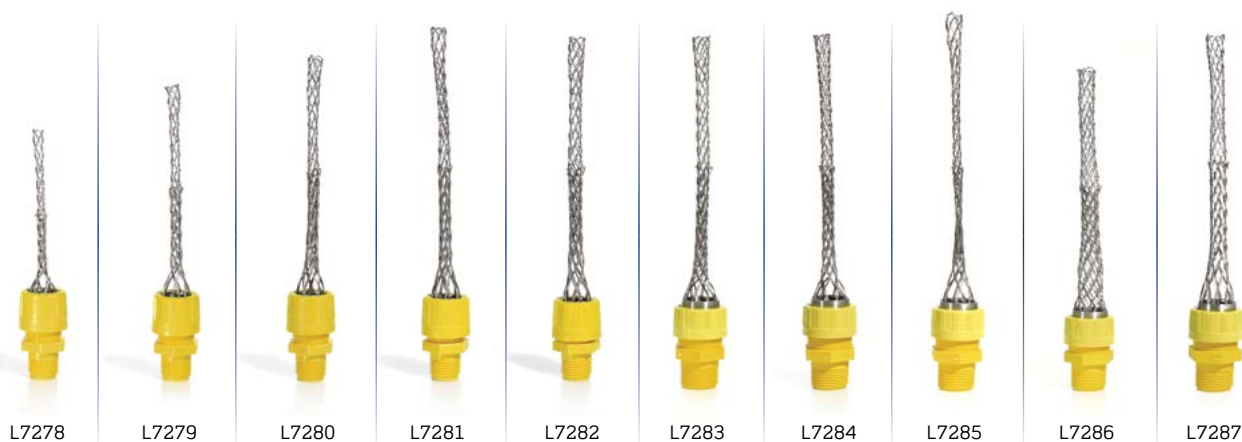

Portable GFCI Devices

Automatic and Manual Reset GFCI Cord Sets and Power Supply Cords

Leviton's automatic and manual reset GFCI devices are now sleeker and more rugged than ever. And, while these devices are fully OSHA compliant for use on job sites, they are also perfect for use in a variety of temporary power applications, including recreation vehicles, marine vehicles, portable pools, portable generators, submersible pumps, vending machines and more.

GFA15-6C



Features and Benefits

- Rainproof, outdoor rated GFCI module
- Fully complies with NEC and OSHA regulations for construction sites
- Manual reset cord sets (yellow body) will NOT automatically reset ON when power is restored after a power interruption — RESET button must be actuated
- Automatic reset cord sets (black body) automatically reset ON when plugged in or when power is restored after a power interruption



Continued on next page

Continued from previous page

Features and Benefits

- Power indicator light goes OFF if GFCI trips, power is interrupted or GFCI is unplugged
- Open-neutral protection immediately trips the GFCI if the neutral conductor on the line side is opened, eliminating the possibility of the GFCI having a live hot leg
- Custom cord lengths and configurations available as special order
- Impact-resistant thermoplastic cover and body
- Water-resistant enclosure sealed by ultrasonic welding
- Fully complies with NEC and OSHA regulations for construction sites
- UL listed cord sets and user-attachables; UL recognized power supply cords; complies with UL Standard 943 as a Class A GFCI
- CSA Certified
- Backed by a limited 2-year warranty

Automatic Reset GFCI Cord Sets and Power Supply Cords

Rating 15A-120V		
NEMA	 5-15P	 5-15R
Description	Color	Cat. No.
2 ft. Cord Set, Molded, Straight Blade Plug and Connector	Black	GFA15-2C
6 ft. Cord Set, Molded, Straight Blade Plug and Connector	Black	GFA15-6C
25 ft. Cord Set, Molded, Straight Blade Plug and Connector	Black	GFA15-25C
3 ft. Cord Set, Molded, Straight Blade Plug and Triple Tap Connector	Black	GFA15-3TC
37 ft. Power Supply Cord, Molded, Straight Blade Plug, No Connector	Black	GFA15-37E
Rating 20A-120V		
NEMA	 5-20P	 5-20R
Description	Color	Cat. No.
3 ft. Cord Set, Molded, Straight Blade Plug and Connector	Black	GFA20-3C
37 ft. Power Supply Cord Molded, Straight Blade Plug, No Connector	Black	GFA20-37E
Rating 20A-120V		
NEMA	 L5-20P	 L5-20R
Description	Color	Cat. No.
3 ft. Cord Set, Locking Plug and Connector	Black	GFA20-3LC



GFA15-3TC



GFA20-37E









GFA20-3C

Portable GFCI Cord Sets

Power Supply Cords | **Industrial**



Manual Reset GFCI Cord Sets and Power Supply Cords

Manual Reset GFCI Cord Sets  		
Rating		15A-120V
NEMA		  5-15P 5-15R
Description	Color	Cat. No.
3 ft. Cord Set, Molded, Straight Blade Plug and Connector, 12-3 SJTW Cord	Yellow	GFM15-3C
25 ft. Cord Set, Molded, Straight Blade Plug and Connector	Yellow	GFM15-25C
3 ft. Cord Set, Molded, Straight Blade Plug and Triple Tap Connector, 12-3 SJTW Cord	Yellow	GFM15-3TC
3 ft. Cord Set, Molded, Straight Blade Plug and Connector, 14-3 SJTW Cord, one end features a 14W47 Wetguard® Plug, other end features a 15W47 Wetguard® Connector	Yellow	GFM15-3WC
Rating		20A-120V
NEMA		  5-20P 5-20R
Description	Color	Cat. No.
3 ft. Cord Set, Molded, Straight Blade Plug and Connector, 12-3 SJTW Cord	Yellow	GFM20-3C
3 ft. Cord Set, Molded, Straight Blade, Plug and Connector, 12-3 SJTW Cord, one end features a 14W33 Wetguard® Plug, other end features a 15W33 Wetguard® Connector	Yellow	GFM20-3WC



GFM20-3C

SPOTLIGHT

Safe & Enjoyable Entertainment Experiences

Leviton offers a comprehensive line of temporary power products for the entertainment market. Our solutions provide seamless integration of lighting fixtures and controls for spectacular scenes and allow electrical connections to power temporary locations. For more information visit www.leviton.com/entertainment.



GFCI User Attachables

Features and Benefits

- UL 943 Class A GFCI operation with open-neutral protection
- May be pre-wired to cable of any specified length up to 50 feet
- Accept — #18 thru #12 cord sizes Type SJ or ST
- Power indicator light goes off if GFCI trips, power is interrupted or GFCI is unplugged
- Backed by a limited 2-year warranty

16693



16694







Polycarbonate, ultrasonically welded body provides long service life and excellent resistance to harsh weather

Accepts 12 AWG to 18 AWG 3-wire flexible cord (SJ or ST Type)

Terminal chamber sealed with silicon and foam rubber gaskets for superior protection against moisture

User Attachable Devices

Right Angle GFCI Plug  			
Rating		15A-120V	20A-120V
NEMA		 5-15P	 5-20P
Description	Color	Cat. No.	Cat. No.
Automatic Reset	Black	16693*	16793*
Manual Reset	Yellow	16694*	16794*

*Please add -1 to the Cat. No. for bulk pack of 20



16693

Power Distribution Box and Power Cords

Features and Benefits

The Box — Power Distribution Boxes

- For temporary use in industrial and commercial maintenance and repair stations (construction, entertainment, amusement sites, trade shows, convention halls) where portable power is needed
- Weatherproof covers prevent moisture from entering contacts and nuisance tripping
- Clear port hole panel for circuit breaker viewing
- Reinforced metal housing and legs withstand abuse
- Backed by a limited 1-year warranty

Power Cords

- Flexible, abrasion-resistant construction for reliable performance to -31°F
- Raintight covers satisfy NEC Article 410-57(b) requirements
- Raintight covers are rated NEMA 3R

Generator Inlet Kits

- Installed outside and used to connect generators to indoor electrical panels
- Ideal for safe applications when electrical panels are not located close to the exterior of a building
- Kit consists of inlet, box, and waterproof flip lid for NEMA 3R protection
- Available in 20 and 30A offerings

The Box — Power Distribution Boxes

Description	Cat. No.
(6) 20A 120V Locking, GFCI Protected (1) 30A 250V Locking, Non-GFCI Protected	PB101
(6) 20A 120V Weather-Resistant Straight Blade, GFCI Protected (1) 30A 250V Locking, Non-GFCI Protected	PB103-W

Power Cords

Description	Cat. No.
100 ft. Temporary Power Cord w/Weather-Resistant 50A, 120/250V Plug and Connector	A9519100BL
50 ft. Temporary Power Cord w/Weather-Resistant 50A, 120/250V Plug and Connector	A9519050BL

Generator Inlet Kits

Rating	
Description	Cat. No.
Generator Inlet Kit, 20A, 125/250V, Includes Flanged Inlet, Weatherproof Cover and FD Box — Gray	37820-100-KIT
<ul style="list-style-type: none"> • Corresponding Connector: 2413 (L14-20R) • Replacement Inlet: 2415 (L14-20P) 	
Generator Inlet Kit, 30A, 125/250V, Includes Flanged Inlet, Weatherproof Cover and FD Box — Gray	37830-100-KIT
<ul style="list-style-type: none"> • Corresponding Connector: 2713 (L14-30R) • Replacement Inlet: 2715 (L14-30P) 	



PB101-SGF



KRS-A9519



37820-100-KIT