

## Datasheet

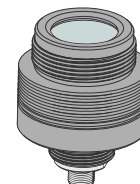

For complete technical information about this product, including installation instructions, application requirements and guidelines, configuration, performance, technical specifications, dimensions, and/or accessories, go to <https://www.bannerengineering.com/qtr/GS60> and locate the product manual, p/n 243622, in the Downloads section. Use of this document assumes familiarity with pertinent industry standards and practices.



The following items may be needed in the appropriate quantity or length for the installation. See the Accessories section in the GS60 Pro Multicolor Guide Spotlight manual for options.

- MQDEC-5xx cordset
- SMB30A mounting bracket
- SMBAMS30P mounting bracket
- ACC-GS60 M48 front mount

## Model Key

Housing	Color	Lens Angle	Control	Connection
<b>GS60P</b>	<b>RGBW</b>	<b>L9</b>		<b>Q</b>
60 mm diameter Pro-enabled Guide Spotlight	RGBW = Multicolor	9 = ± 9 degree lens	Blank = Constant power plus three inputs	Q = Integral 5-pin M12 male quick-disconnect connector



**CAUTION:**  
Risk Group 2: Possibly hazardous optical radiation emitted from this product.

Do not stare at the operating lamp. May be harmful to the eyes. Risk Group 2 (RG 2) products generally do not pose a realistic optical hazard if aversion responses limit the exposure duration or where lengthy exposures are unrealistic.

- IEC 62471

## Wiring

Diagram	Pinout	Pin Number	Wire Color	Description
		Pin 1	Brown	12 V DC to 30 V DC
		Pin 2	White	Input 2: 12 V DC to 30 V DC
		Pin 3	Blue	DC common
		Pin 4	Black	Input 1: 12 V DC to 30 V DC
		Pin 5	Gray	Input 3: 12 V DC to 30 V DC

### Default Color Definition

	Red	Yellow	Green	Cyan	Blue	Magenta	White
Input 1	X	X				X	X
Input 2		X	X	X			X
Input 3				X	X	X	X

An "X" denotes an active input. For example, when Input 1 and Input 3 are active, the spotlight is magenta.

## Specifications

Refer to the manual for complete information.

### Supply Voltage

12 V DC to 30 V DC

### Supply Protection Circuitry

Protected against reverse polarity and transient voltages

### Mounting

30 × 1.5 mm thread base mount

### Connections

Integral 5-pin M12 male quick-disconnect connector

### Supply Current

Typical Current			Maximum Current
12 V DC	24 V DC	30 V DC	A
0.415	0.2	0.165	0.5

### Construction

Black anodized aluminum housing  
Polycarbonate window  
Nickel-plated quick-disconnect connector  
Black anodized aluminum mounting nut

### Operating Temperature

−40 °C to +50 °C (−40 °F to +122 °F)

### Storage Temperature

−40 °C to +70 °C (−40 °F to +158 °F)

Environmental Rating  
IP66, IP67



## Required Overcurrent Protection



**WARNING:** Electrical connections must be made by qualified personnel in accordance with local and national electrical codes and regulations.

Overcurrent protection is required to be provided by end product application per the supplied table.

Overcurrent protection may be provided with external fusing or via Current Limiting, Class 2 Power Supply.

Supply wiring leads < 24 AWG shall not be spliced.

For additional product support, go to [www.bannerengineering.com](http://www.bannerengineering.com).

Supply Wiring (AWG)	Required Overcurrent Protection (A)	Supply Wiring (AWG)	Required Overcurrent Protection (A)
20	5.0	26	1.0
22	3.0	28	0.8
24	1.0	30	0.5

## Default Indicator Characteristics

Color	Dominant Wavelength (nm) or Color Temperature (CCT)	Color Coordinates <sup>(1)</sup>		Lumen Output (Typical at 25 °C)
		X	Y	
Blue	450	0.1584	0.022	31.7
Green	520	0.1493	0.6898	188
Red	623	0.688	0.3043	140
Orange	597	0.5811	0.3812	155
Amber	587	0.5224	0.4228	161.1
Yellow	575	0.4435	0.4789	156.6
Lime Green	559	0.3582	0.5405	166.2
Spring Green	515	0.1499	0.6279	177.5
Cyan	495	0.1581	0.3757	158.6
Sky Blue	487	0.1554	0.2657	143
Violet	-	0.2358	0.1094	114.6
Magenta	-	0.404	0.2096	146.1
Rose	-	0.5462	0.2664	145
White	4000K	0.3792	0.3902	257.8

## Banner Engineering Corp Limited Warranty

Banner Engineering Corp. warrants its products to be free from defects in material and workmanship for one year following the date of shipment. Banner Engineering Corp. will repair or replace, free of charge, any product of its manufacture which, at the time it is returned to the factory, is found to have been defective during the warranty period. This warranty does not cover damage or liability for misuse, abuse, or the improper application or installation of the Banner product.

**THIS LIMITED WARRANTY IS EXCLUSIVE AND IN LIEU OF ALL OTHER WARRANTIES WHETHER EXPRESS OR IMPLIED (INCLUDING, WITHOUT LIMITATION, ANY WARRANTY OF MERCHANTABILITY OR FITNESS FOR A PARTICULAR PURPOSE), AND WHETHER ARISING UNDER COURSE OF PERFORMANCE, COURSE OF DEALING OR TRADE USAGE.**

This Warranty is exclusive and limited to repair or, at the discretion of Banner Engineering Corp., replacement. **IN NO EVENT SHALL BANNER ENGINEERING CORP. BE LIABLE TO BUYER OR ANY OTHER PERSON OR ENTITY FOR ANY EXTRA COSTS, EXPENSES, LOSSES, LOSS OF PROFITS, OR ANY INCIDENTAL, CONSEQUENTIAL OR SPECIAL DAMAGES RESULTING FROM ANY PRODUCT DEFECT OR FROM THE USE OR INABILITY TO USE THE PRODUCT, WHETHER ARISING IN CONTRACT OR WARRANTY, STATUTE, TORT, STRICT LIABILITY, NEGLIGENCE, OR OTHERWISE.**

Banner Engineering Corp. reserves the right to change, modify or improve the design of the product without assuming any obligations or liabilities relating to any product previously manufactured by Banner Engineering Corp. Any misuse, abuse, or improper application or installation of this product or use of the product for personal protection applications when the product is identified as not intended for such purposes will void the product warranty. Any modifications to this product without prior express approval by Banner Engineering Corp will void the product warranties. All specifications published in this document are subject to change; Banner reserves the right to modify product specifications or update documentation at any time. Specifications and product information in English supersede that which is provided in any other language. For the most recent version of any documentation, refer to: [www.bannerengineering.com](http://www.bannerengineering.com).

For patent information, see [www.bannerengineering.com/patents](http://www.bannerengineering.com/patents).

<sup>(1)</sup> Refer to CIE 1931 chromaticity diagram or color chart, to show equivalent color with indicated color coordinates.